

Pratissoli

2018

Pompe e Accessori
Pumps and Accessories



**INTERPUMP
GROUP**

Plunger pump series

KE	pag. 4
KT_{LP}	pag. 5
KT_{HP}	pag. 6
KV	pag. 7
KF	pag. 8
HF	pag. 9
VFH	pag. 10
KS	pag. 11
HS	pag. 12
VKH	pag. 13
MW_{LP}	pag. 14
MW_{HP}	pag. 15
SM	pag. 16
MK_{LP}	pag. 17
MK_{HP}	pag. 18
MF	pag. 19
MK_S_{LP}	pag. 20
MK_S_{HP}	pag. 21
LK	pag. 22
SKH	pag. 23
SR_{LP}	pag. 24
SR_{HP}	pag. 25
TR_{LP}	pag. 26
TR_{HP}	pag. 27

Piston pump series

KT45M	pag. 28
KF5M	pag. 29
MF7M	pag. 30
MK9M	pag. 31

Accessories

	pag. 32 - 39
---	--------------

High Pressure Hoses

	pag. 40 - 41
--	--------------

Packages

	pag. 42
---	---------



**INTERPUMP
GROUP**

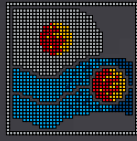

Pratissoli



KE series

25HP



STANDARD	Tipo pompa	Portata		Pressione			g/min	Potenza		€
	Pump type	L/min	US Gpm	bar	MPa	p.s.i.	r.p.m.	hp	kW	
	KE 20	30	7.9	300	30	4350	1450	25	18,4	3.310,00
	KE 22	37	9.8	250	25	3620	1450	25	18,4	3.310,00
	KE 24	45	11.9	210	21	3045	1450	25	18,4	3.310,00
	KE 28 H	61	16.1	150	15	2170	1450	25	18,4	3.310,00
	KE 30 H	70	18.5	130	13	1885	1450	25	18,4	3.310,00
	KE 36 H	100	26.4	100	10	1450	1450	25	18,4	3.310,00

70.SS INOX	Tipo pompa	Portata		Pressione			g/min	Potenza		€
	Pump type	L/min	US Gpm	bar	MPa	p.s.i.	r.p.m.	hp	kW	
	SS70 30	30	7.92	200	20	2900	1450	16	11,7	6.144,00
	SS70 37	37	9.77	200	20	2900	1450	19	14,0	6.144,00
	SS70 45	45	11.89	200	20	2900	1450	24	17,6	6.144,00
	SS70 61H	61	16.11	150	15	2175	1450	24	17,6	6.144,00
	SS70 70H	70	18.49	130	13	1885	1450	24	17,6	6.144,00
	SS70 91H	100	26.40	100	10	1450	1450	26	19,1	6.144,00

70.SN INOX	Tipo pompa	Portata		Pressione			g/min	Potenza		€
	Pump type	L/min	US Gpm	bar	MPa	p.s.i.	r.p.m.	hp	kW	
	SN70 30	30	8.0	300	30	4350	1450	25	18,4	3.990,00
	SN70 37	37	10.0	250	25	3650	1450	25	18,4	3.990,00
	SN70 45	45	11.9	210	21	3045	1450	25	18,4	3.990,00
	SN70 61	61	16.1	150	15	2170	1450	25	18,4	3.990,00
	SN70 70	70	18.5	130	13	1880	1450	25	18,4	3.990,00
	SN70 91	100	26.4	100	10	1450	1450	26	19,1	3.990,00

Y-PACK (Standard)	€
	GEAR 48 cc. 4.540,00
	PISTON 64 cc. 5.030,00
	ZRPM1 166,00

DRIVE OPTIONS	€	€
Predisposizione per motore idraulico SAE J744-B albero scanalato 13T 16/32 DP <i>Hydraulic motor mount SAE J744-B spline shaft 13T 16/32 DP</i>	209,00	Predisposizione presa di forza ausiliaria opposta albero moto <i>Auxiliary P.T.O. opposite to shaft side</i>
Flangia supporto per azionamenti diretti <i>Flange for direct drive mount</i>	155,00	ZFH70SB - Kit campana per accoppiamento a motori idraulici SAE J 744 tipo B-B <i>ZFH70SB - Bell housing for SAE J 744 B-B hydraulic motor</i>
ZGH70SB - Giunto flessibile <i>ZGH70SB - Flexible coupling</i>	382,00	

PUMP OPTIONS	€	€
Flushing System	660,00	ATEX - II 2GD ck T4/T135°C
		on request



KTLP series

35HP

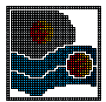

STANDARD

Tipo pompa Pump type	Portata Volume		Pressione Pressure			g/min r.p.m.	Potenza Power		€
	L/min	US Gpm	bar	MPa	p.s.i.		hp	kW	
KT 24	51	13.5	250	25	2900	1450	33	24,4	2.790,00
	62	16.3	200	20	2900	1750	32	23,6	
KT 28	70	18.4	200	20	2900	1450	36	26,7	2.790,00
	84	22.2	175	17,5	2540	1750	38	28,0	
KT 30	80	21.1	175	17,5	2540	1450	36	26,7	2.790,00
	96	25.5	140	14	2030	1750	35	26,0	
KT 32	91	24.0	150	15	2175	1450	35	26,0	2.790,00
KT 36	115	30.4	120	12	1740	1450	36	26,7	2.790,00
	125	33.1	125	12,5	1813	1580	41	29,9	
KT 40	142	37.5	100	10	1450	1450	37	27,1	2.790,00

HY-PACK (Standard)

€



GEAR 48 cc.

4.020,00



GEAR 53 cc.

3.760,00



PISTON 64 cc.

4.510,00



ZRPM1

166,00

DRIVE OPTIONS

€

€



Predisposizione per motore idraulico
SAE J744-B albero scanalato
13T 16/32 DP
*Hydraulic motor mount SAE J744-B
splined shaft 13T 16/32 DP*

209,00



Predisposizione presa di forza
ausiliaria opposta albero moto
Auxiliary P.T.O. opposite to shaft side

217,00



Flangia supporto per
azionamenti diretti
Flange for direct drive mount

155,00



ZFH70SB - Kit campana per
accoppiamento a motori idraulici
SAE J 744 tipo B-B
*ZFH70SB - Bell housing for
SAE J 744 B-B hydraulic motor*

312,00



ZGH70SB - Giunto flessibile
ZGH70SB - Flexible coupling

382,00

PUMP OPTIONS

€

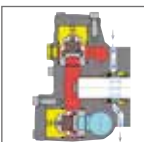

Flushing System

660,00

KTHP series

35HP



STANDARD	Tipo pompa Pump type	Portata Volume		Pressione Pressure			g/min r.p.m.	Potenza Power		€
		L/min	US Gpm	bar	MPa	p.s.i.		hp	kW	
	KT 16	27	7.2	500	50	7250	1750	36	26,2	3.610,00
	KT 18	29	7.6	500	50	7250	1450	37	27,5	3.610,00
		35	9.2	400	40	5800	1750	36	26,5	
	KT 19*	30	7.9	500	50	7250	1450	39	28,7	3.610,00
		36	9.5	400	40	5800	1750	38	27,9	
	KT 20	36	9.4	400	40	5800	1450	37	27,1	3.610,00
		43	11.3	320	32	4640	1750	36	26,2	
	KT 22	43	11.4	320	32	4640	1450	36	26,3	3.610,00
		52	13.7	250	25	3625	1750	34	24,8	

(*) Disponibile da maggio 2018 / Available from may 2018

HY-PACK (Standard)

€



GEAR 48 cc.

4.840,00



GEAR 53 cc.

4.580,00



PISTON 64 cc.

5.330,00



ZRPM1

166,00

DRIVE OPTIONS

€

€



Predisposizione per motore idraulico
SAE J744-B albero scanalato
13T 16/32 DP
*Hydraulic motor mount SAE J744-B
spline shaft 13T 16/32 DP*

209,00



Predisposizione presa di forza
ausiliaria opposta albero moto
Auxiliary P.T.O. opposite to shaft side

217,00



Flangia supporto per
azionamenti diretti
Flange for direct drive mount

155,00



ZFH70SB - Kit campana per
accoppiamento a motori idraulici
SAE J 744 tipo B-B
*ZFH70SB - Bell housing for
SAE J 744 B-B hydraulic motor*

312,00



ZGH70SB - Giunto flessibile
ZGH70SB - Flexible coupling

382,00

PUMP OPTIONS

€

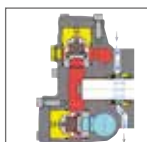

Flushing System

660,00

KV series

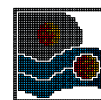

35HP

STANDARD	Tipo pompa Pump type	Portata Volume		Pressione Pressure			g/min r.p.m.	Potenza Power		€
		L/min	US Gpm	bar	MPa	p.s.i.		hp	kW	
	KV 12	12,8	3.4	1100	110	16000	1450	36,5	26,9	6.920,00
		15,4	4.1	1100	110	16000	1750	44	32,4	
	KV 14	17,4	4.6	800	80	11600	1450	36,1	26,6	6.920,00
		21,0	5.5	800	80	11600	1750	43,6	32,0	

HY-PACK (Standard)

€



GEAR 48 cc.

8.150,00



PISTON 64 cc.

8.640,00



ZRPM1

166,00

DRIVE OPTIONS

€

€



Predisposizione per motore idraulico
SAE J744-B albero scanalato
13T 16/32 DP
*Hydraulic motor mount SAE J744-B
splined shaft 13T 16/32 DP*

209,00



Predisposizione presa di forza
ausiliaria opposta albero moto
Auxiliary P.T.O. opposite to shaft side

217,00



Flangia supporto per
azionamenti diretti
Flange for direct drive mount

155,00



ZFH70SB - Kit campana per
accoppiamento a motori idraulici
SAE J 744 tipo B-B
*ZFH70SB - Bell housing for
SAE J 744 B-B hydraulic motor*

312,00



ZGH70SB - Giunto flessibile
ZGH70SB - Flexible coupling

382,00

CONNECTION KITS

€

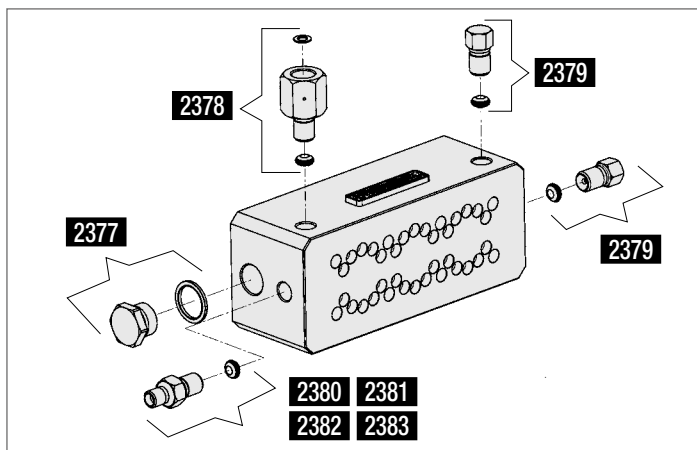

KIT2377	INLET	G 3/4"	44,90
KIT2378	OUTLET	G 3/8" HP - G 1/2"	288,00
KIT2379	OUTLET	G 3/4"	94,80
KIT2380	OUTLET	G 3/8" HP - G 1/4"	254,00
KIT2381	OUTLET	G 3/8" HP - G 3/8"	254,00
KIT2382	OUTLET	G 3/8" HP - M14x 1,5	254,00
KIT2383	OUTLET	G 3/8" HP - M20x 1,5	254,00

KF series



50HP

STANDARD

Tipo pompa Pump type	Portata Volume		Pressione Pressure			g/min r.p.m.	Potenza Power		€
	L/min	US Gpm	bar	MPa	p.s.i.		hp	kW	
KF 28	93	24.5	210	21	3045	1000	50	37,0	4.270,00
KF 30	106	28.0	200	20	2900	1000	55	40,0	4.270,00
KF 32	120	31.7	180	18	2610	1000	56	41,2	4.270,00
KF 36	153	40.0	130	13	1900	1000	52	38,2	4.270,00
KF 40	170	45.0	110	11	1600	900	49	36,0	4.270,00

71.SS INOX

Versioni inox
AISI 316 L
Temperatura max 85°C

AISI 316 L version
Max water temp. 85°C

Tipo pompa Pump type	Portata Volume		Pressione Pressure			g/min r.p.m.	Potenza Power		€
	L/min	US Gpm	bar	MPa	p.s.i.		hp	kW	
SS71 93	93	24.57	200	20	2900	1000	48	35,3	9.488,00
SS71 106	106	28.0	200	20	2900	1000	55	40,0	9.488,00
SS71 153	122	32.2	160	16	2300	800	51	37,5	9.488,00
	137	36.2	140	14	2050	900	50	37,0	9.488,00
	153	40.42	130	13	1885	1000	52	38,2	9.488,00
SS71 170	170	44.9	100	10	1450	900	44	36,0	9.488,00

71.SN INOX

Versioni inox
AISI 420
Temperatura max 85°C

AISI 420 version
Max water temp. 85°C

Tipo pompa Pump type	Portata Volume		Pressione Pressure			g/min r.p.m.	Potenza Power		€
	L/min	US Gpm	bar	MPa	p.s.i.		hp	kW	
SN71 93	93	24.57	210	21	3050	1000	50	37,0	5.420,00
SN71 106	106	28.0	200	20	2900	1000	55	40,0	5.420,00
SN71 153	122	32.2	160	16	2300	800	51	37,5	5.420,00
	137	36.2	140	14	2050	900	50	37,0	5.420,00
	153	40.42	130	13	1885	1000	52	38,2	5.420,00
SN71 170	170	44.9	110	11	1600	900	49	36,0	5.420,00

RECYCLED FLUID



Tipo pompa Pump type	Portata Volume		Pressione Pressure			g/min r.p.m.	Potenza Power		€
	L/min	US Gpm	bar	MPa	p.s.i.		hp	kW	
KFR - 28	93	24.5	210	21	3045	1000	50	37,0	4.460,00
KFR - 30	106	28.0	200	20	2900	1000	55	40,0	4.460,00
KFR - 32	120	31.7	180	18	2610	1000	56	41,2	4.460,00
KFR - 36	153	40.0	130	13	1900	1000	52	38,2	4.460,00
KFR - 40	170	45.0	110	11	1600	900	49	36,0	4.460,00

HY-PACK (Standard)



GEAR 117 cc.	5.980,00
PISTON 84 cc.	6.060,00
PISTON 108 cc.	6.120,00
 ZRPM1	166,00

DRIVE OPTIONS

€

€



Predisposizione per motore idraulico
SAE J744-C albero scanalato
14T 12/24 DP
Hydraulic motor mount SAE J744-C
splined shaft 14T 12/24 DP

230,00



Predisposizione presa di forza
ausiliaria opposta albero moto
Auxiliary P.T.O. opposite to shaft side

268,00



Flangia supporto per
azionamenti diretti
Flange for direct drive mount

155,00



ZFH71SC - Kit campana per
accoppiamento a motori idraulici
SAE J 744 tipo C
ZFH71SC - Bell housing for SAE J
744 C hydraulic motor

322,00



Riduttore / Gearbox
R 1:1,25 - R 1:1,5 - R 1:1,83

1.180,00



ZGH71SC - Giunto flessibile
ZGH71SC - Flexible coupling

481,00

PUMP OPTIONS

€

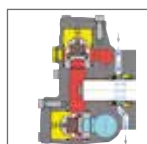

Flushing System

857,00



ATEX - II 2GD ck T4/T135°C

on request

HF series

50HP

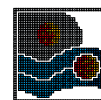

STANDARD

Tipo pompa Pump type	Portata Volume		Pressione Pressure			g/min r.p.m.	Potenza Power		€
	L/min	US Gpm	bar	MPa	p.s.i.		hp	kW	
HF 18	30	8.1	600	60	8700	800	48	35,5	6.680,00
	38	10.1	500	50	7250	1000	50	36,8	
HF 20	47	12.4	400	40	5800	1000	50	36,8	5.110,00
HF 22	57	15.0	350	35	5075	1000	50	36,8	5.110,00
HF 25	73	19.3	280	28	4060	1000	50	36,8	5.110,00

HF-N INOX

Versioni inox duplex
ASTM F51
(testata da billetta)
rif. 71961100

Duplex ASTM F51
s.s. version
block style manifold
ref. 71961100

Tipo pompa Pump type	Portata Volume		Pressione Pressure			g/min r.p.m.	Potenza Power		€
	L/min	US Gpm	bar	MPa	p.s.i.		hp	kW	
HFN 22	57	15.0	350	35	5075	1000	50	36,8	13.590,00
HFN 25	73	19.3	280	28	4060	1000	50	36,8	13.590,00

HY-PACK (Standard)

€

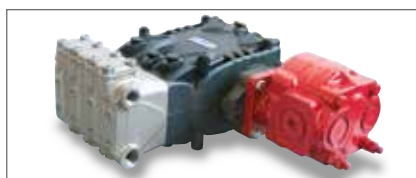

GEAR 117 cc.	8.180,00
GEAR 117 cc. HF18	9.750,00



PISTON 84 cc.	8.250,00
PISTON 108 cc.	8.310,00
PISTON 84 cc. HF18	9.820,00
PISTON 108 cc. HF18	9.880,00



ZRPM1	166,00
-------	--------

DRIVE OPTIONS

€

€



Predisposizione per motore idraulico
SAE J744-C albero scanalato
14T 12/24 DP
Hydraulic motor mount SAE J744-C
spline shaft 14T 12/24 DP

230,00



Predisposizione presa di forza
ausiliaria opposta albero moto
Auxiliary P.T.O. opposite to shaft side

268,00



Flangia supporto per
azionamenti diretti
Flange for direct drive mount

155,00



ZFH71SC - Kit campana per
accoppiamento a motori idraulici
SAE J 744 tipo C
ZFH71SC - Bell housing for SAE J
744 C hydraulic motor

322,00



Riduttore / Gearbox
R 1:1,25 - R 1:1,5 - R 1:1,83

1.180,00



ZGH71SC - Giunto flessibile
ZGH71SC - Flexible coupling

481,00

PUMP OPTIONS

€

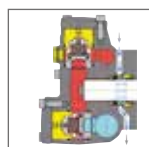

Flushing System

1.080,00



ATEX - II 2GD ck T4/T135°C

on request

VFH series

50HP



STANDARD	Tipo pompa Pump type	Portata Volume		Pressione Pressure			g/min r.p.m.	Potenza Power		€
		L/min	US Gpm	bar	MPa	p.s.i.		hp	kW	
	VFH 12	12,5	3.3	1500	150	21750	750	50	36,8	13.120,00
		15	4.0	1200	120	17500	900	50	36,8	
	VFH 14	17	4.5	1100	110	16000	750	50	36,8	13.120,00
		23	6.0	800	80	11600	1000	50	36,8	

HY-PACK (Standard)

€



GEAR 117 cc. 14.830,00

GEAR 184 cc. 15.090,00



PISTON 108 cc. 14.960,00

PISTON 130 cc. 15.550,00



ZRPM1 166,00

DRIVE OPTIONS

€

€



Predisposizione per motore idraulico
SAE J744-C albero scanalato
14T 12/24 DP 230,00
*Hydraulic motor mount SAE J744-C
spline shaft 14T 12/24 DP*



Predisposizione presa di forza
ausiliaria opposta albero moto
Auxiliary P.T.O. opposite to shaft side 268,00



Flangia supporto per
azionamenti diretti 155,00
Flange for direct drive mount



ZFH71SC - Kit campana per
accoppiamento a motori idraulici
SAE J 744 tipo C 322,00
*ZFH71SC - Bell housing for SAE J
744 C hydraulic motor*



Riduttore / Gearbox 1.180,00
R 1:1,25 - R 1:1,5 - R 1:1,83



ZGH71SC - Giunto flessibile
ZGH71SC - Flexible coupling 481,00

CONNECTION KITS

€

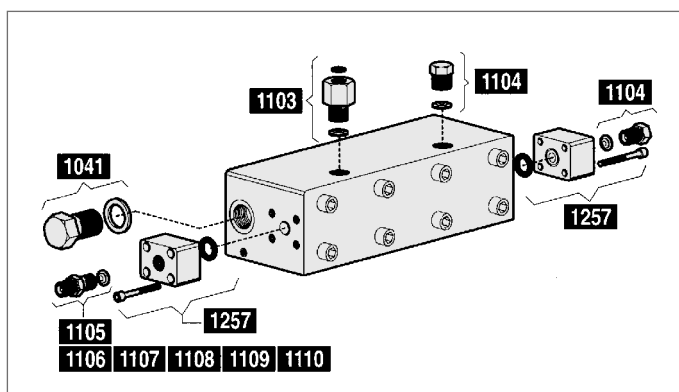

KIT1041	INLET	G 3/4"	145,00
KIT1103	OUTLET	G 1/2" HP - G 1/2"	338,00
KIT1104	OUTLET	G 1/2" HP	235,00
KIT1105	OUTLET	G 1/2" HP - G 1/4"	276,00
KIT1106	OUTLET	G 1/2" HP - G 3/8"	312,00
KIT1107	OUTLET	G 1/2" HP - M14x 1,5	284,00
KIT1108	OUTLET	G 1/2" HP - M20x 1,5	284,00
KIT1109	OUTLET	G 1/2" HP - M22x 1,5	284,00
KIT1110	OUTLET	G 1/2" HP - M24x 1,5	368,00
KIT1257	OUTLET	G 1/2" HP	420,00

KS series

75HP

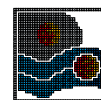

STANDARD	Tipo pompa Pump type	Portata Volume		Pressione Pressure			Riduttore r.p.m.			Potenza Power hp kW	€
		L/min	US Gpm	bar	MPa	p.s.i.	1:1,25	1:1,5	1:1,83		
	KS 28	110	29.1	250	25	3625	1500 / 1800 / 2200			75 55,0	9.020,00
	KS 32	145	38.3	200	20	2900	1500 / 1800 / 2200			75 55,0	9.020,00
	KS 36	183	48.3	160	16	2320	1500 / 1800 / 2200			75 55,0	9.020,00
	KS 40	226	59.7	140	14	2000	1500 / 1800 / 2200			75 55,0	9.020,00

HY-PACK (Standard)

€



GEAR 117 cc. 10.120,00

GEAR 184 cc. 10.380,00



PISTON 108 cc. 10.250,00

PISTON 130 cc. 10.840,00



ZRPM1 166,00

DRIVE OPTIONS

€

€



Predisposizione per motore idraulico
SAE J744-C albero scanalato
14T 12/24 DP
*Hydraulic motor mount SAE J744-C
splined shaft 14T 12/24 DP*

230,00



Predisposizione presa di forza
ausiliaria opposta albero moto
Auxiliary P.T.O. opposite to shaft side

268,00



Flangia supporto per
azionamenti diretti
Flange for direct drive mount

155,00



ZFH71SC - Kit campana per
accoppiamento a motori idraulici
SAE J 744 tipo C
*ZFH71SC - Bell housing for SAE J
744 C hydraulic motor*

322,00



Presa diretta senza riduttore
1200 g/min
*Direct drive without gearbox
1200 r.p.m.*

- 600,00



ZGH71SC - Giunto flessibile
ZGH71SC - Flexible coupling

481,00



HS series

75HP



STANDARD	Tipo pompa Pump type	Portata Volume		Pressione Pressure			Riduttore r.p.m.			Potenza Power	€	
		L/min	US Gpm	bar	MPa	p.s.i.	1:1,25	1:1,5	1:1,83	hp		kW
	HS 18	46	12.1	600	60	8700	1500 / 1800 / 2200			75	55,0	9.290,00
	HS 20	57	15.1	600	60	8700	1500 / 1800 / 2200			75	55,0	9.290,00
	HS 22	68	18.0	600	60	8700	1500 / 1800 / 2200			75	55,0	9.290,00

HY-PACK (Standard) €

	GEAR 117 cc.	10.400,00
	GEAR 184 cc.	10.660,00
	PISTON 108 cc.	10.530,00
	PISTON 130 cc.	11.120,00
	ZRPM1	166,00

DRIVE OPTIONS € €

	Predisposizione per motore idraulico SAE J744-C albero scanalato 14T 12/24 DP <i>Hydraulic motor mount SAE J744-C spline shaft 14T 12/24 DP</i>	230,00		Predisposizione presa di forza ausiliaria opposta albero moto <i>Auxiliary P.T.O. opposite to shaft side</i>	268,00
	Flangia supporto per azionamenti diretti <i>Flange for direct drive mount</i>	155,00		ZFH71SC - Kit campana per accoppiamento a motori idraulici SAE J 744 tipo C <i>ZFH71SC - Bell housing for SAE J 744 C hydraulic motor</i>	322,00
	Presa diretta senza riduttore 1200 g/min <i>Direct drive without gearbox 1200 r.p.m.</i>	- 600,00		ZGH71SC - Giunto flessibile <i>ZGH71SC - Flexible coupling</i>	481,00

PUMP OPTIONS €

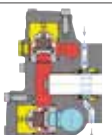
	Flushing System	1.080,00
---	-----------------	----------

VKH series

75HP

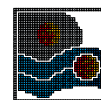

STANDARD	Tipo pompa Pump type	Portata Volume		Pressione Pressure			Riduttore r.p.m.			Potenza Power	€	
		L/min	US Gpm	bar	MPa	p.s.i.	1:1,25	1:1,5	1:1,83	hp		kW
	VKH 12	20	5.3	1500	150	21750	1500 / 1800 / 2200			75	55,0	16.790,00
	VKH 14	28	7.4	1100	110	15950	1500 / 1800 / 2200			75	55,0	16.790,00

HY-PACK (Standard)

€



GEAR 117 cc. 17.890,00

GEAR 184 cc. 18.060,00



PISTON 108 cc. 17.940,00

PISTON 130 cc. 18.530,00



ZRPM1 166,00

DRIVE OPTIONS

€

€



Predisposizione per motore idraulico
SAE J744-C albero scanalato
14T 12/24 DP
*Hydraulic motor mount SAE J744-C
spline shaft 14T 12/24 DP*

230,00



Predisposizione presa di forza
ausiliaria opposta albero moto
Auxiliary P.T.O. opposite to shaft side

268,00



Flangia supporto per
azionamenti diretti
Flange for direct drive mount

155,00



ZFH71SC - Kit campana per
accoppiamento a motori idraulici
SAE J 744 tipo C
*ZFH71SC - Bell housing for SAE J
744 C hydraulic motor*

322,00



Presa diretta senza riduttore
1200 g/min
*Direct drive without gearbox
1200 r.p.m.*

- 600,00



ZGH71SC - Giunto flessibile
ZGH71SC - Flexible coupling

481,00

CONNECTION KITS

€

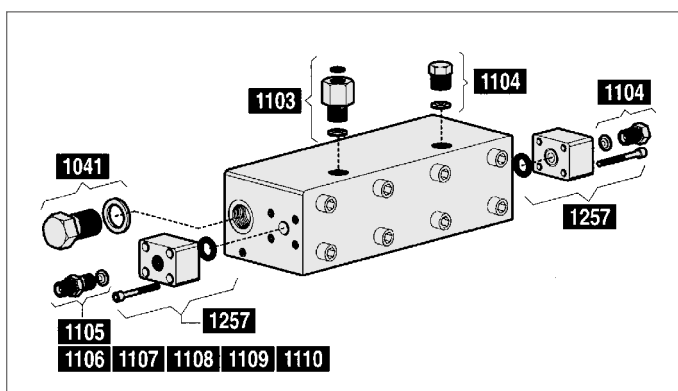

KIT1041	INLET	G 3/4"	145,00
KIT1103	OUTLET	G 1/2" HP - G 1/2"	338,00
KIT1104	OUTLET	G 1/2" HP	235,00
KIT1105	OUTLET	G 1/2" HP - G 1/4"	276,00
KIT1106	OUTLET	G 1/2" HP - G 3/8"	312,00
KIT1107	OUTLET	G 1/2" HP - M14x 1,5	284,00
KIT1108	OUTLET	G 1/2" HP - M20x 1,5	284,00
KIT1109	OUTLET	G 1/2" HP - M22x 1,5	284,00
KIT1110	OUTLET	G 1/2" HP - M24x 1,5	368,00
KIT1257	OUTLET	G 1/2" HP	420,00

MWLP series



100HP

STANDARD	Tipo pompa Pump type	Portata Volume L/min US Gpm		Pressione Pressure bar MPa p.s.i.			Riduttore r.p.m. 1:1,875 1:2,238 1:2,722 1:3,211				Potenza Power hp kW		€
	MW 45	267	70.5	155	15,5	2248	1500 / 1800 / 2200 / 2600				100	74	11.990,00
MW 50	330	87.2	125	12,5	1813	1500 / 1800 / 2200 / 2600				100	74	11.990,00	
MW 55	399	105.4	125	12,5	1813	1500 / 1800 / 2200 / 2600				100	74	11.990,00	

MWN Versioni inox DUPLEX ASTM F51 (testata da billetta) e inox 17/4 ph (valvole aspir e mandata). Duplex ASTM F51 s.s. versions, black style manifold, 17/4 ph s.s. in/out valves.	Tipo pompa Pump type	Portata Volume L/min US Gpm		Pressione Pressure bar MPa p.s.i.			Riduttore / Gearbox g/min r.p.m.				Potenza Power hp kW		€
	MWN 45	267	70.6	155	15,5	2248	800/1500/1800/2200/2600				100	74	32.240,00
MWN 50	330	87.2	125	12,5	1813	800/1500/1800/2200/2600				100	74	32.240,00	
MWN 55	399	105.4	100	10	1450	800/1500/1800/2200/2600				100	74	32.240,00	

RECYCLED FLUID 	Tipo pompa Pump type	Portata Volume L/min US Gpm		Pressione Pressure bar MPa p.s.i.			Riduttore / Gearbox g/min r.p.m.				Potenza Power hp kW		€
	MW-R 45	267	70.6	155	15,5	2248	1500/1800/2200/2600				107	79	12.510,00
MW-R 50	330	87.2	125	12,5	1813	1500/1800/2200/2600				107	79	12.510,00	
MW-R 55	399	105.4	100	10	1450	1500/1800/2200/2600				107	79	12.510,00	

HY-PACK (Standard)	€
	GEAR 117 cc. 13.990,00
	GEAR 184 cc. 14.240,00
	PISTON 108 cc. 14.120,00
	PISTON 130 cc. 14.710,00
	ZRPM1 166,00

DRIVE OPTIONS	€	€	
 Predisposizione per motore idraulico SAE J744-C albero scanalato 14T 12/24 DP Hydraulic motor mount SAE J744-C spline shaft 14T 12/24 DP	504,00	 Predisposizione presa di forza ausiliaria opposta albero moto Auxiliary P.T.O. opposite to shaft side	316,00
 Presa diretta senza riduttore 800 g/min Direct drive without gearbox 800 r.p.m.	- 600,00	 ATEX ON REQUEST	ATEX - II 2GD ck T4/T135°C on request

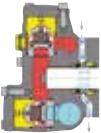
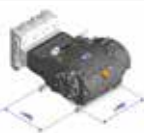
PUMP OPTIONS	€	€	
 Flushing System	2.400,00	 KIT 2152 - Staffe retrofit MS/VS KIT 2152 Retrofit rails to MS / VS pumps	405,00

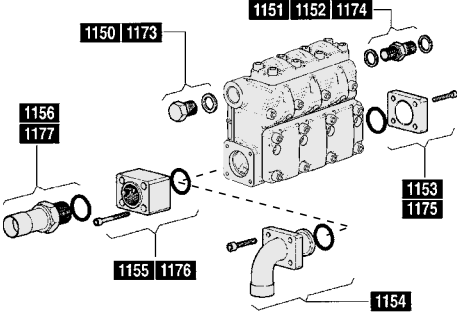
CONNECTION KITS	€																																																								
	<table border="1"> <thead> <tr> <th colspan="4">MW45 - MW 50 - MW 55 - MWR 45 - MWR 50 - MWR 55</th> </tr> </thead> <tbody> <tr><td>KIT1150</td><td>OUTLET</td><td>G 1" 1/4</td><td>51,50</td></tr> <tr><td>KIT1151</td><td>OUTLET</td><td>G 1" 1/4 - G 1" 1/2</td><td>113,00</td></tr> <tr><td>KIT1152</td><td>OUTLET</td><td>G 1" 1/4 - G 1" 1/4</td><td>101,00</td></tr> <tr><td>KIT1153</td><td>INLET</td><td>-</td><td>102,00</td></tr> <tr><td>KIT1154</td><td>INLET</td><td>O.D. Ø 76 mm E</td><td>538,00</td></tr> <tr><td>KIT1155</td><td>INLET</td><td>G 2" 1/2</td><td>217,00</td></tr> <tr><td>KIT1156</td><td>INLET</td><td>O.D. Ø 76 mm E</td><td>485,00</td></tr> </tbody> </table> <table border="1"> <thead> <tr> <th colspan="4">MWN45 - MWN 50 - MWN 55 - MWNR 45 - MWNR 50 - MWNR 55</th> </tr> </thead> <tbody> <tr><td>KIT1173</td><td>OUTLET</td><td>G 1" 1/4</td><td>175,00</td></tr> <tr><td>KIT1174</td><td>OUTLET</td><td>G 1" 1/4 - G 1" 1/4</td><td>291,00</td></tr> <tr><td>KIT1175</td><td>INLET</td><td>-</td><td>518,00</td></tr> <tr><td>KIT1176</td><td>INLET</td><td>G 2" 1/2</td><td>722,00</td></tr> <tr><td>KIT1177</td><td>INLET</td><td>O.D. Ø 76 mm E</td><td>1.484,00</td></tr> </tbody> </table>	MW45 - MW 50 - MW 55 - MWR 45 - MWR 50 - MWR 55				KIT1150	OUTLET	G 1" 1/4	51,50	KIT1151	OUTLET	G 1" 1/4 - G 1" 1/2	113,00	KIT1152	OUTLET	G 1" 1/4 - G 1" 1/4	101,00	KIT1153	INLET	-	102,00	KIT1154	INLET	O.D. Ø 76 mm E	538,00	KIT1155	INLET	G 2" 1/2	217,00	KIT1156	INLET	O.D. Ø 76 mm E	485,00	MWN45 - MWN 50 - MWN 55 - MWNR 45 - MWNR 50 - MWNR 55				KIT1173	OUTLET	G 1" 1/4	175,00	KIT1174	OUTLET	G 1" 1/4 - G 1" 1/4	291,00	KIT1175	INLET	-	518,00	KIT1176	INLET	G 2" 1/2	722,00	KIT1177	INLET	O.D. Ø 76 mm E	1.484,00
MW45 - MW 50 - MW 55 - MWR 45 - MWR 50 - MWR 55																																																									
KIT1150	OUTLET	G 1" 1/4	51,50																																																						
KIT1151	OUTLET	G 1" 1/4 - G 1" 1/2	113,00																																																						
KIT1152	OUTLET	G 1" 1/4 - G 1" 1/4	101,00																																																						
KIT1153	INLET	-	102,00																																																						
KIT1154	INLET	O.D. Ø 76 mm E	538,00																																																						
KIT1155	INLET	G 2" 1/2	217,00																																																						
KIT1156	INLET	O.D. Ø 76 mm E	485,00																																																						
MWN45 - MWN 50 - MWN 55 - MWNR 45 - MWNR 50 - MWNR 55																																																									
KIT1173	OUTLET	G 1" 1/4	175,00																																																						
KIT1174	OUTLET	G 1" 1/4 - G 1" 1/4	291,00																																																						
KIT1175	INLET	-	518,00																																																						
KIT1176	INLET	G 2" 1/2	722,00																																																						
KIT1177	INLET	O.D. Ø 76 mm E	1.484,00																																																						

MWHP series

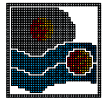

100HP

STANDARD	Tipo pompa Pump type	Portata Volume		Pressione Pressure			Riduttore r.p.m.				Potenza Power	€
		L/min	US Gpm	bar	MPa	p.s.i.	1:1,875	1:2,238	1:2,722	1:3,211	hp	
	MW 32	135	35.7	300	30	4350	1500 / 1800 / 2200 / 2600				100 74	11.990,00
	MW 36	171	45.2	240	24	3480	1500 / 1800 / 2200 / 2600				100 74	11.990,00
	MW 40	211	55.7	210	21	3045	1500 / 1800 / 2200 / 2600				100 74	11.990,00

MWN	Tipo pompa Pump type	Portata Volume		Pressione Pressure			Riduttore / Gearbox		Potenza Power	€
		L/min	US Gpm	bar	MPa	p.s.i.	g/min r.p.m.	hp	kW	
Versioni inox DUPLEX ASTM F51 (testata da billetta) e inox 17/4 ph (valvole aspir e mandata). Duplex ASTM F51 s.s. versions, block style manifold, 17/4 ph s.s. in/out valves.	MWN 32	135	35.7	300	30	4350	800/1500/1800/2200/2600		100 74	32.240,00
	MWN 36	171	45.2	240	24	3480	800/1500/1800/2200/2600		100 74	32.240,00
	MWN 40	211	55.7	210	21	3045	800/1500/1800/2200/2600		115 85	32.240,00

RECYCLED FLUID	Tipo pompa Pump type	Portata Volume		Pressione Pressure			Riduttore / Gearbox		Potenza Power	€
		L/min	US Gpm	bar	MPa	p.s.i.	g/min r.p.m.	hp	kW	
	MW-R 32	135	35.7	300	30	4350	1500/1800/2200/2600		100 74	12.510,00
	MW-R 36	171	45.2	240	24	3480	1500/1800/2200/2600		100 74	12.510,00
	MW-R 40	211	55.7	210	21	3045	1500/1800/2200/2600		115 85	12.510,00

HY-PACK (Standard)

	€
	GEAR 117 cc. 13.990,00
	GEAR 184 cc. 14.240,00
	PISTON 108 cc. 14.120,00
	PISTON 130 cc. 14.710,00
	ZRPM1 166,00

DRIVE OPTIONS

	€	€
	Predisposizione per motore idraulico SAE J744-C albero scanalato 14T 12/24 DP Hydraulic motor mount SAE J744-C spline shaft 14T 12/24 DP	504,00
	Presenza diretta senza riduttore 800 g/min Direct drive without gearbox 800 r.p.m.	- 600,00
	Predisposizione presa di forza ausiliaria opposta albero moto Auxiliary P.T.O. opposite to shaft side	316,00

PUMP OPTIONS

	€	€
	Flushing System	2.400,00
	KIT 2152 - Staffe retrofit MS/VS KIT 2152 Retrofit rails to MS / VS pumps	405,00
	ATEX ON REQUEST	ATEX - II 2GD ck T4/T135°C on request

SM series

100HP



STANDARD

Tipo pompa Pump type	Portata Volume		Pressione Pressure			Riduttore r.p.m.				Potenza Power		€
	L/min	US Gpm	bar	MPa	p.s.i.	1:1,875	1:2,238	1:2,722	1:3,211	hp	kW	
SM 14	26	6.9	1500	150	21750	1500 / 1800 / 2200 / 2600				101	74	24.590,00
SM 16	34	9.0	1200	120	17400	1500 / 1800 / 2200 / 2600				106	78	24.590,00
SM 18	43	11.4	900	90	13050	1500 / 1800 / 2200 / 2600				101	74	24.590,00
SM 20	53	14.0	750	75	10875	1500 / 1800 / 2200 / 2600				103	76	24.590,00
SM 22	64	16.9	600	60	8700	1500 / 1800 / 2200 / 2600				100	74	24.590,00
SM 24	76	20.1	500	50	7250	1500 / 1800 / 2200 / 2600				99	73	24.590,00

HY-PACK (Standard)

€



GEAR 117 cc. 26.600,00

GEAR 184 cc. 26.860,00



PISTON 108 cc. 26.730,00

PISTON 130 cc. 27.320,00



ZRPM1 166,00

DRIVE OPTIONS

€

€



Predisposizione per motore idraulico
SAE J744-C albero scanalato
14T 12/24 DP
*Hydraulic motor mount SAE J744-C
spline shaft 14T 12/24 DP*

504,00



Predisposizione presa di forza
ausiliaria opposta albero moto
Auxiliary P.T.O. opposite to shaft side

316,00



Presenza diretta senza riduttore
800 g/min
*Direct drive without gearbox
800 r.p.m.*

- 600,00

PUMP OPTIONS

€

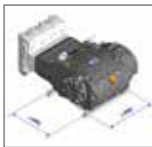

KIT 2152 - Staffe retrofit MS/VS
*KIT 2152 Retrofit rails to MS / VS
pumps*

405,00

CONNECTION KITS

€

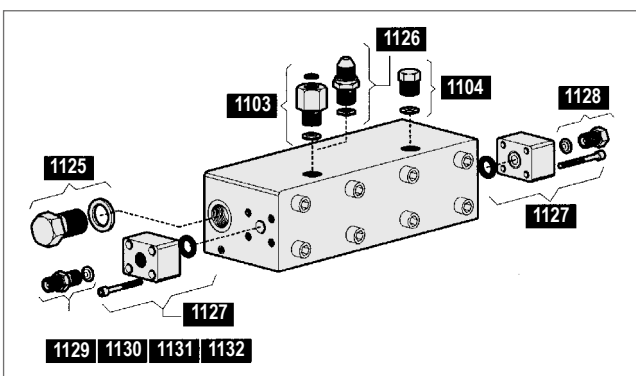

KIT1103	OUTLET	G 1/2" HP - G 1/2"	338,00
KIT1104	OUTLET	G 1/2" HP	235,00
KIT1105	INLET	G 1" 1/2	288,00
KIT1106	OUTLET	G 1/2" HP - 5/8"UNF	351,00
KIT1107	OUTLET	G 3/4" HP	514,00
KIT1108	OUTLET	G 3/4" HP	241,00
KIT1109	OUTLET	G 3/4" HP - G 3/8"	275,00
KIT1110	OUTLET	G 3/4" HP - M20x 1,5	275,00
KIT1111	OUTLET	G 3/4" HP - M22x 1,5	304,00
KIT1112	OUTLET	G 3/4" HP - M24x 1,5	526,00

MKLP series

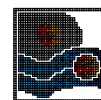



150HP



STANDARD	Tipo pompa Pump type	Portata Volume L/min US Gpm		Pressione Pressure bar MPa p.s.i.			Riduttore r.p.m. 1:2,65 1:3,29	Potenza Power hp kW		€
	MK 55	290	76.6	200	20	2900	1500 / 1800	151	111	16.580,00
MK 60	346	91.4	170	17	2465	1500 / 1800	153	112	16.580,00	
MK 65	406	107.3	150	15	2175	1500 / 1800	158	116	16.580,00	

RECYCLED FLUID 	Tipo pompa Pump type	Portata Volume L/min US Gpm		Pressione Pressure bar MPa p.s.i.			Riduttore / Gearbox g/min r.p.m.	Potenza Power hp kW		€
	MK-R 55	290	76.6	200	20	2900	1500 / 1800 / 2050	151	111	17.100,00
MK-R 60	346	91.4	170	17	2465	1500 / 1800 / 2050	153	112	17.100,00	
MK-R 65	406	107.3	150	15	2175	1500 / 1800 / 2050	158	116	17.100,00	

HY-PACK (Standard) €

	GEAR 184 cc.	18.830,00
	PISTON 130 cc.	19.300,00
	ZRPM1	166,00

DRIVE OPTIONS €

	Predisposizione per motore idraulico SAE J744-C albero scanalato 14T 12/24 DP <i>Hydraulic motor mount SAE J744-C splined shaft 14T 12/24 DP</i>	504,00		Predisposizione per motore idraulico SAE J744-D albero scanalato 13T 8/16 DP <i>Hydraulic motor mount SAE J744-D splined shaft 13T 8/16 DP</i>	504,00
--	---	--------	---	---	--------

PUMP OPTIONS €

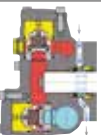
	Flushing System	2.940,00
---	-----------------	----------

CONNECTION KITS €

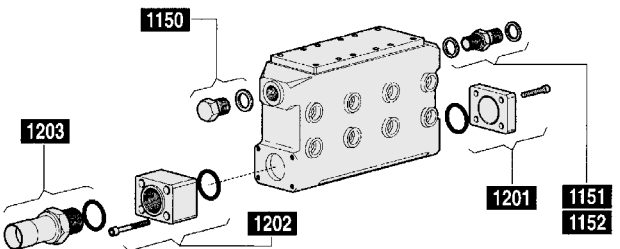
	KIT1150	OUTLET	G 1" 1/4	51,50
	KIT1151	OUTLET	G 1" 1/4 - G 1" 1/2	113,00
	KIT1152	OUTLET	G 1" 1/4 - G 1" 1/4	101,00
	KIT1201	INLET	-	122,00
	KIT1202	INLET	G 3"	265,00
	KIT1203	INLET	O.D. Ø 90 mm E	520,00

MKHP series





150HP

STANDARD	Tipo pompa Pump type	Portata Volume L/min US Gpm		Pressione Pressure bar MPa p.s.i.			Riduttore r.p.m. 1:2,65 1:3,29	Potenza Power hp kW		€
	MK 40	154	40.5	400	40	5800	1500 / 1800	160	118	16.580,00
MK 45	194	51.3	300	30	4350	1500 / 1800	151	111	16.580,00	
MK 50	240	63.4	250	25	3625	1500 / 1800	156	115	16.580,00	

RECYCLED FLUID 	Tipo pompa Pump type	Portata Volume L/min US Gpm		Pressione Pressure bar MPa p.s.i.			Riduttore / Gearbox g/min r.p.m.	Potenza Power hp kW		€
	MK-R 40	154	40.5	400	40	5800	1500 / 1800 / 2050	160	118	17.100,00
MK-R 45	194	51.3	300	30	4350	1500 / 1800 / 2050	151	111	17.100,00	
MK-R 50	240	63.4	250	25	3625	1500 / 1800 / 2050	156	115	17.100,00	

HY-PACK (Standard) €

	GEAR 184 cc.	18.830,00
	PISTON 130 cc.	19.300,00
	ZRPM1	166,00

DRIVE OPTIONS €

	Predisposizione per motore idraulico SAE J744-C albero scanalato 14T 12/24 DP <i>Hydraulic motor mount SAE J744-C spline shaft 14T 12/24 DP</i>	504,00		Predisposizione per motore idraulico SAE J744-D albero scanalato 13T 8/16 DP <i>Hydraulic motor mount SAE J744-D spline shaft 13T 8/16 DP</i>	504,00
--	--	--------	---	--	--------

PUMP OPTIONS €

	Flushing System	2.940,00
---	-----------------	----------

MF series

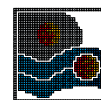

150HP

STANDARD	Tipo pompa Pump type	Portata Volume		Pressione Pressure			Riduttore r.p.m.				Potenza Power		€
		L/min	US Gpm	bar	MPa	p.s.i.	1:1,875	1:2,238	1:2,722	1:3,211	hp	kW	
	MF 45	269	71	200	20	2900	1500 / 1800 / 2200 / 2600				140	103	16.290,00
	MF 50	332	88	170	17	2465	1500 / 1800 / 2200 / 2600				147	108	16.290,00
	MF 55	401	106	140	14	2030	1500 / 1800 / 2200 / 2600				147	108	16.290,00

HY-PACK (Standard)

€



GEAR 184 cc.

18.530,00



PISTON 130 cc.

19.000,00



ZRPM1

166,00

DRIVE OPTIONS

€

€



Predisposizione per motore idraulico
SAE J744-C albero scanalato
14T 12/24 DP
*Hydraulic motor mount SAE J744-C
spline shaft 14T 12/24 DP*

504,00



Predisposizione presa di forza
ausiliaria opposta albero moto
Auxiliary P.T.O. opposite to shaft side

316,00



Presa diretta senza riduttore
800 g/min
Direct drive without gearbox
800 r.p.m.

- 600,00

CONNECTION KITS

€

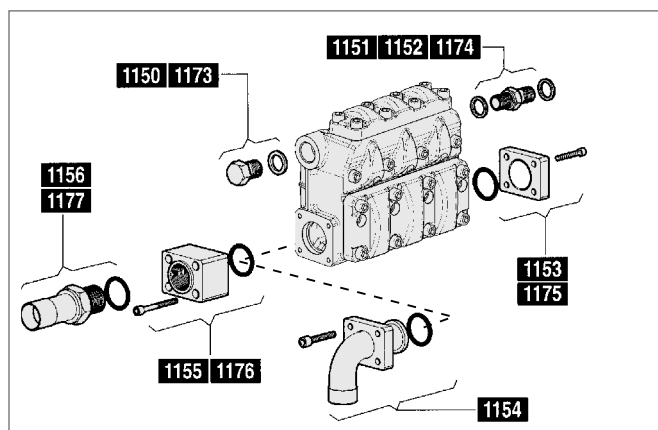

KIT1150	OUTLET	G 1" 1/4	51,50
KIT1151	OUTLET	G 1" 1/4 - G 1" 1/2	113,00
KIT1152	OUTLET	G 1" 1/4 - G 1" 1/4	101,00
KIT1153	INLET	-	102,00
KIT1154	INLET	O.D. Ø 76 mm E	538,00
KIT1155	INLET	G 2" 1/2	217,00
KIT1156	INLET	O.D. Ø 76 mm E	485,00

MKSLP series



180HP

STANDARD	Tipo pompa Pump type	Portata Volume L/min US Gpm		Pressione Pressure bar MPa p.s.i.			Riduttore r.p.m. 1:2,22 1:2,65 1:3,29	Potenza Power hp kW	€
	MKS 55	347 91.7	200 20 2900	1500 / 1800 / 2200			180 132,5	18.140,00	
MKS 60	413 109.4	170 17 2465	1500 / 1800 / 2200			182 134,0	18.140,00		
MKS 65	485 128.0	150 15 2175	1500 / 1800 / 2200			189 139,0	18.140,00		

RECYCLED FLUID 	Tipo pompa Pump type	Portata Volume L/min US Gpm		Pressione Pressure bar MPa p.s.i.			Riduttore / Gearbox g/min r.p.m.	Potenza Power hp kW	€
	MKS-R 55	347 91.7	200 20 2900	1500 / 1800 / 2200 / 2500			180 132,5	18.660,00	
MKS-R 60	413 109.4	170 17 2465	1500 / 1800 / 2200 / 2500			182 134,0	18.660,00		
MKS-R 65	485 128.0	150 15 2175	1500 / 1800 / 2200 / 2500			189 139,0	18.660,00		

HY-PACK (Standard)

€



GEAR 184 cc.

20.390,00



PISTON 130 cc.

20.860,00



ZRPM1

166,00

DRIVE OPTIONS

€

€



Predisposizione per motore idraulico
SAE J744-C albero scanalato
14T 12/24 DP
Hydraulic motor mount SAE J744-C
splined shaft 14T 12/24 DP

504,00



Predisposizione per motore idraulico
SAE J744-D albero scanalato
13T 8/16 DP
Hydraulic motor mount SAE J744-D
splined shaft 13T 8/16 DP

504,00

PUMP OPTIONS

€

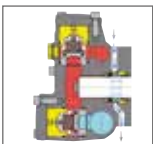

Flushing System

2.950,00

CONNECTION KITS

€

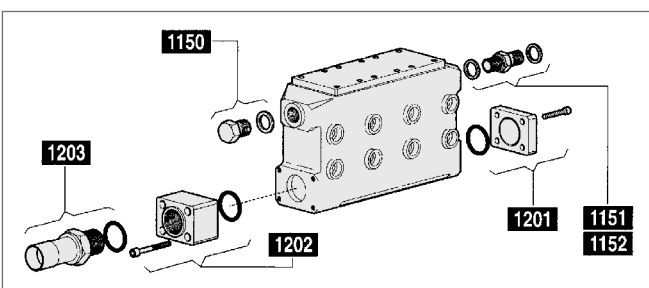

KIT1150	OUTLET	G 1" 1/4	51,50
KIT1151	OUTLET	G 1" 1/4 - G 1" 1/2	113,00
KIT1152	OUTLET	G 1" 1/4 - G 1" 1/4	101,00
KIT1201	INLET	-	122,00
KIT1202	INLET	G 3"	265,00
KIT1203	INLET	O.D. Ø 90 mm E	520,00

MKSHP series

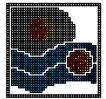

180HP

STANDARD	Tipo pompa Pump type	Portata Volume L/min US Gpm		Pressione Pressure bar MPa p.s.i.			Riduttore r.p.m. 1:2,22 1:2,65 1:3,29	Potenza Power hp kW		€
	MKS 40	183	48.4	400	40	5800	1500 / 1800 / 2200	190	140	18.140,00
MKS 45	232	61.3	300	30	4350	1500 / 1800 / 2200	181	133	18.140,00	
MKS 50	287	75.8	250	25	3625	1500 / 1800 / 2200	186	137	18.140,00	

RECYCLED FLUID 	Tipo pompa Pump type	Portata Volume L/min US Gpm		Pressione Pressure bar MPa p.s.i.			Riduttore / Gearbox g/min r.p.m.	Potenza Power hp kW		€
	MKS-R 40	183	48.4	400	40	5800	1500 / 1800 / 2200 / 2500	190	140	18.660,00
MKS-R 45	232	61.3	300	30	4350	1500 / 1800 / 2200 / 2500	181	133	18.660,00	
MKS-R 50	287	75.8	250	25	3625	1500 / 1800 / 2200 / 2500	186	137	18.660,00	

HY-PACK (Standard)

€



GEAR 184 cc.

20.390,00



PISTON 130 cc.

20.860,00



ZRPM1

166,00

DRIVE OPTIONS

€



Predisposizione per motore idraulico
SAE J744-C albero scanalato
14T 12/24 DP
*Hydraulic motor mount SAE J744-C
spline shaft 14T 12/24 DP*

504,00



Predisposizione per motore idraulico
SAE J744-D albero scanalato
13T 8/16 DP
*Hydraulic motor mount SAE J744-D
spline shaft 13T 8/16 DP*

504,00

PUMP OPTIONS

€

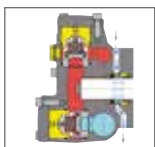

Flushing System

2.950,00

LK series



LK 36 / LK 40 / LK 45



LK 50 / LK 55 / LK 60

180HP

STANDARD

Tipo pompa Pump type	Portata/Volume - Riduttore/Gearbox						Pressione Pressure			Potenza Power		€
	1500 r.p.m.		1750 r.p.m.		1900 r.p.m.		bar	MPa	p.s.i.	hp	kW	
	L/min	US Gpm	L/min	US Gpm	L/min	US Gpm						
LK 36	140	37.0	152	40.2	154	40.7	400	40	5800	161	118	24.840,00
LK 40	173	45.7	188	49.7	190	50.2	350	35	5075	173	127	24.840,00
LK 45	218	57.6	238	62.9	241	63.7	280	28	4060	176	129	24.840,00
LK 50	269	71.1	294	77.7	297	78.5	230	23	3335	177	130	24.840,00
LK 55	326	86.1	355	93.8	360	95.1	190	19	2755	178	131	24.840,00
LK 60	388	102.5	423	111.8	428	113.1	160	16	2320	178	131	24.840,00

CONNECTION KITS

€

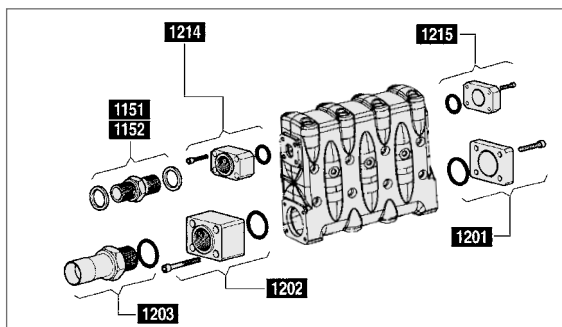

KIT1151	OUTLET	G 1" 1/4 - G 1" 1/2	113,00
KIT1152	OUTLET	G 1" 1/4 - G 1" 1/4	101,00
KIT1201	INLET	-	122,00
KIT1202	OUTLET	G 3"	267,00
KIT1203	OUTLET	O.D. Ø 90 mm E	520,00
KIT1214	OUTLET	G 1" 1/4	288,00
KIT1215	OUTLET	-	233,00

LK-N series

180HP



LK-N INOX

Versioni inox DUPLEX
ASTM F51
(testata da billetta)
e inox 17/4 ph
(valvole aspir e mandata).

Duplex ASTM F51
s.s. versions, block style
manifold, 17/4 ph s.s.
in/out valves.

Tipo pompa Pump type	Portata Volume		Pressione Pressure			Riduttore / Gearbox g/min r.p.m.	Potenza Power		€
	L/min	US Gpm	bar	MPa	p.s.i.		hp	kW	
LK-N 36	140	37.0	400	40	5800	1500/1750/1900	161	118,0	47.090,00
LK-N 40	173	45.7	350	35	5075	1500/1750/1900	173	127,2	47.090,00
LK-N 45	218	57.6	280	28	4060	1500/1750/1900	176	129,0	47.090,00
LK-N 50	269	71.1	230	23	3335	1500/1750/1900	177	130,0	47.090,00
LK-N 55	326	86.1	190	19	2755	1500/1750/1900	178	131,0	47.090,00
LK-N 60	388	102.5	160	16	2320	1500/1750/1900	178	131,0	47.090,00

CONNECTION KITS

€

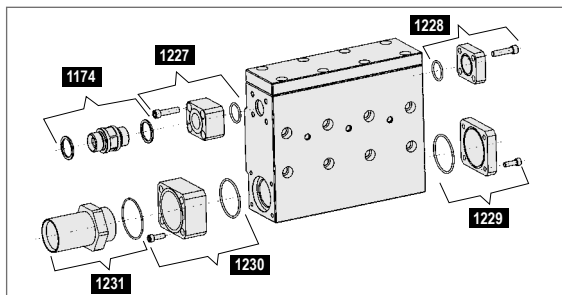

LK-N 50 - LK-N 55 - LK-N 60

KIT1174	OUTLET	G 1" 1/4 - G 1" 1/4	291,00
KIT1227	OUTLET	G 1" 1/4	764,00
KIT1228	OUTLET	-	614,00
KIT1229	INLET	-	648,00
KIT1230	INLET	G 3"	1.013,00
KIT1231	INLET	G 3" - Ø 90 mm	3.143,00

PUMP OPTIONS

€

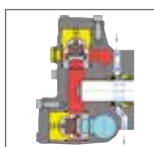

Flushing System

4.900,00



ATEX - II 2GD ck T4/T135°C

on request

SKH series

180HP

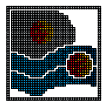

STANDARD

Tipo pompa Pump type	Portata/Volume - Riduttore/Gearbox				Pressione Pressure			Potenza Power				€
	1500 r.p.m. 1:2,95		1750 r.p.m. 1:3,389		bar	MPa	p.s.i.	1500 r.p.m.		1750 r.p.m.		
	L/min	US Gpm	L/min	US Gpm				hp	kW	hp	kW	
SKH 20	43	11.4	44	11.6	400	40	5800	168	123	171	126	32.900,00
SKH 22	52	13.7	53	14.0	350	35	5075	176	12	179	132	32.900,00
SKH 24	62	16.4	63	16.6	280	28	4060	177	130	180	132	32.900,00
SKH 26	73	19.3	74	19.6	230	23	3335	171	126	173	127	32.900,00
SKH 28	84	22.3	86	22.7	190	19	2755	175	128	179	132	32.900,00
SKH 30	96	25.4	98	25.9	160	16	2320	175	128	178	131	32.900,00

CONNECTION KITS

€

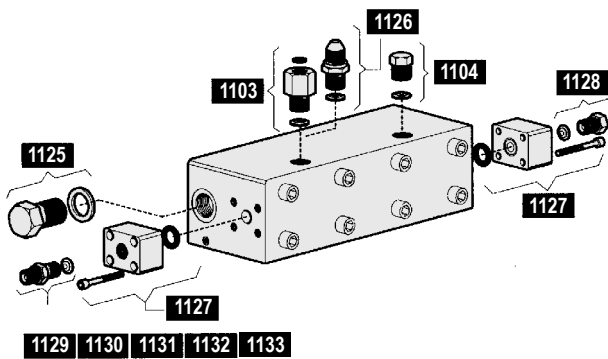

KIT1103	OUTLET	G 1/2" HP - G 1/2"	338,00
KIT1104	OUTLET	G 1/2" HP	235,00
KIT1125	INLET	G 1" 1/2	288,00
KIT1126	OUTLET	G 1/2" HP - 5/8" UNF	351,00
KIT1127	OUTLET	G 3/4" HP	514,00
KIT1128	OUTLET	G 3/4" HP	241,00
KIT1129	OUTLET	G 3/4" HP - G 3/8"	275,00
KIT1130	OUTLET	G 3/4" HP - M20x1,5	275,00
KIT1131	OUTLET	G 3/4" HP - M22x1,5	304,00
KIT1132	OUTLET	G 3/4" HP - M24x1,5	526,00
KIT1133	OUTLET	G 3/4" HP - M36x2	324,00

SRLP series

300HP



STANDARD	Tipo pompa Pump type	Portata Volume		Pressione Pressure			Riduttore r.p.m.			Potenza Power		€
		L/min	US Gpm	bar	MPa	p.s.i.	1:2,90	1:3,46	1:4,23	hp	kW	
	SR 50	276	73	400	40	5800	1500 / 1800 / 2200			287	211	53.870,00
	SR 55	333	88	350	35	5075	1500 / 1800 / 2200			303	223	53.870,00
	SR 60	397	105	300	30	4350	1500 / 1800 / 2200			309	227	53.870,00
	SR 65	466	123	250	25	3625	1500 / 1800 / 2200			302	222	53.870,00
	SR 70	540	143	220	22	3190	1500 / 1800 / 2200			309	227	53.870,00
	SR 75	620	164	200	20	2900	1500 / 1800 / 2200			322	237	53.870,00

RECYCLED FLUID	Tipo pompa Pump type	Portata Volume		Pressione Pressure			Riduttore Gearbox			Potenza Power		€
		L/min	US Gpm	bar	MPa	p.s.i.	g/min	r.p.m.	hp	kW		
	SR-R 50	276	73	400	40	5800	1500 / 1800 / 2200			287	211	54.470,00
	SR-R 55	333	88	350	35	5075	1500 / 1800 / 2200			303	223	54.470,00
	SR-R 60	397	105	300	30	4350	1500 / 1800 / 2200			309	227	54.470,00
	SR-R 65	466	123	250	25	3625	1500 / 1800 / 2200			302	222	54.470,00
	SR-R 70	540	143	220	22	3190	1500 / 1800 / 2200			309	227	54.470,00
	SR-R 75	620	164	200	20	2900	1500 / 1800 / 2200			322	237	54.470,00

CONNECTION KITS €

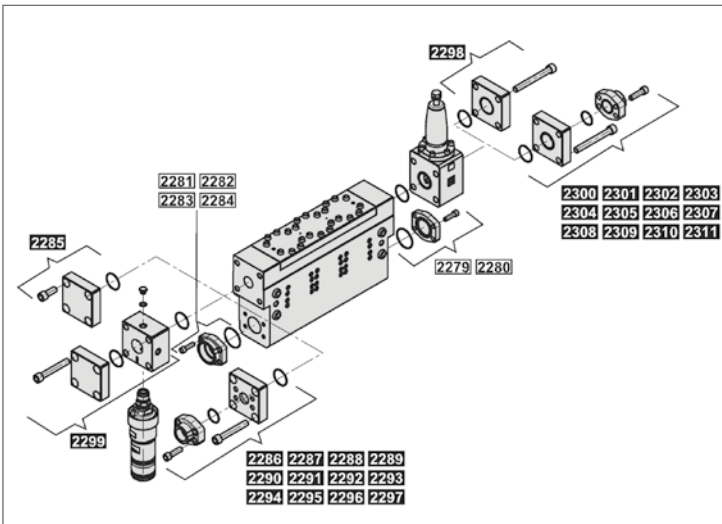

KIT2279	INLET	SAE 3000 Flange Plug	SR TR all	STD	130,00
KIT2280	INLET	SAE 3000 Flange Plug	SR TR all	INOX	610,00
KIT2281	INLET	G 3"	SR TR all	ST5 2.3	189,00
KIT2282	INLET	G 3"	SR TR all	INOX	849,00
KIT2283	INLET	NPT 3"	SR TR all	ST5 2.3	213,00
KIT2284	INLET	NPT 3"	SR TR all	INOX	770,00
KIT2285	OUTLET	Flange Plug	SR TR all	INOX	820,00
KIT2286	OUTLET	SAE 6000 G 1" 1/2	SR TR 50	ST5 2.3	1.030,00
KIT2287	OUTLET	SAE 6000 G 1" 1/2	SR TR 50	INOX	1.551,00
KIT2288	OUTLET	SAE 6000 NPT 1" 1/2	SR TR 50	ST5 2.3	1.119,00
KIT2289	OUTLET	SAE 6000 NPT 1" 1/2	SR TR 50	INOX	1.495,00
KIT2290	OUTLET	SAE 6000 G 2"	SR TR 60-65	ST5 2.3	1.051,00
KIT2291	OUTLET	SAE 6000 G 2"	SR TR 60-65	INOX	1.721,00
KIT2292	OUTLET	SAE 6000 NPT 2"	SR TR 60-65	ST5 2.3	1.111,00
KIT2293	OUTLET	SAE 6000 NPT 2"	SR TR 60-65	INOX	1.686,00
KIT2294	OUTLET	SAE 6000 G 2" 1/2	SR TR 70-75	ST5 2.3	1.357,00
KIT2295	OUTLET	SAE 6000 G 2" 1/2	SR TR 70-75	INOX	2.360,00
KIT2296	OUTLET	SAE 6000 NPT 2" 1/2	SR TR 70-75	ST5 2.3	1.352,00
KIT2297	OUTLET	SAE 6000 NPT 2" 1/2	SR TR 70-75	INOX	3.192,00
KIT2298	OUTLET	Flange Plug RV	SR TR all	INOX	891,00
KIT2299	OUTLET	Safety Valve block + Plug	SR TR all	INOX	2.505,00
KIT2300	OUTLET	SAE 6000 G 1" 1/2 RV	SR TR 50	ST5 2.3	1.101,00
KIT2301	OUTLET	SAE 6000 G 1" 1/2 RV	SR TR 50	INOX	1.622,00
KIT2302	OUTLET	SAE 6000 NPT 1" 1/2 RV	SR TR 50	ST5 2.3	1.190,00
KIT2303	OUTLET	SAE 6000 NPT 1" 1/2 RV	SR TR 50	INOX	1.566,00
KIT2304	OUTLET	SAE 6000 G 2" RV	SR TR 60-65	ST5 2.3	1.122,00
KIT2305	OUTLET	SAE 6000 G 2" RV	SR TR 60-65	INOX	1.792,00
KIT2306	OUTLET	SAE 6000 NPT 2" RV	SR TR 60-65	ST5 2.3	1.182,00
KIT2307	OUTLET	SAE 6000 NPT 2" RV	SR TR 60-65	INOX	1.757,00
KIT2308	OUTLET	SAE 6000 G 2" 1/2 RV	SR TR 70-75	ST5 2.3	1.428,00
KIT2309	OUTLET	SAE 6000 G 2" 1/2 RV	SR TR 70-75	INOX	2.431,00
KIT2310	OUTLET	SAE 6000 NPT 2" 1/2 RV	SR TR 70-75	ST5 2.3	1.423,00
KIT2311	OUTLET	SAE 6000 NPT 2" 1/2 RV	SR TR 70-75	INOX	3.263,00



ATEX - II 2GD ck T4/T135°C

on request

SRHP series

300HP

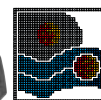

STANDARD	Tipo pompa Pump type	Portata Volume		Pressione Pressure			Riduttore r.p.m.			Potenza Power		€
		L/min	US Gpm	bar	MPa	p.s.i.	1:2,90	1:3,46	1:4,23	hp	kW	
	SR 26	75	19.9	1500	150	21750	1500 / 1800 / 2200			290	213	61.900,00
	SR 30	99	26.5	1200	120	17400	1500 / 1800 / 2200			309	227	61.900,00
	SR 32	113	29.8	1000	100	14500	1500 / 1800 / 2200			293	215	61.900,00
	SR 36	143	37.8	800	80	11600	1500 / 1800 / 2200			297	218	61.900,00

CONNECTION KITS €

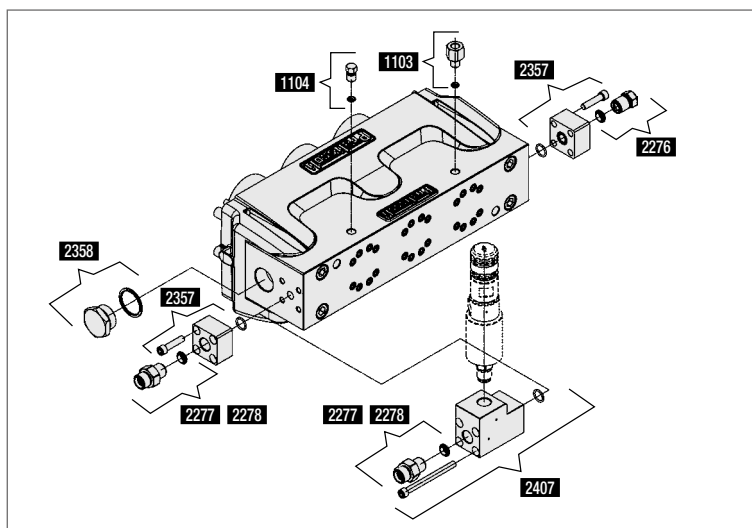

KIT1103	OUTLET	G 1/2" HP - G 1/2"	338,00
KIT1104	OUTLET	G 1/2" HP	235,00
KIT2276	OUTLET	G 1"	343,00
KIT2277	OUTLET	G 1" - M24 x 1,5	495,00
KIT2278	OUTLET	G 1" - M36 x 2	513,00
KIT2357	OUTLET	G 1"	462,00
KIT2358	INLET	G 2" HP	204,00
KIT2407	OUTLET	G 1" HP	1.662,00



ATEX - II 2GD ck T4/T135°C

on request

TRLP series

450HP



STANDARD	Tipo pompa	Portata		Pressione			Riduttore			Potenza		€
	Pump type	L/min	US Gpm	bar	MPa	p.s.i.	1:2,90	1:3,46	1:4,23	hp	kW	
	TR 50	398	105	400	40	5800	1500 / 1800 / 2200			414	304	65.300,00
	TR 55	482	127	350	35	5075	1500 / 1800 / 2200			438	322	65.300,00
	TR 60	573	151	300	30	4350	1500 / 1800 / 2200			446	328	65.300,00
	TR 65	673	178	250	25	3625	1500 / 1800 / 2200			437	321	65.300,00
	TR 70	781	206	220	22	3190	1500 / 1800 / 2200			446	328	65.300,00
	TR 75	896	237	200	20	2900	1500 / 1800 / 2200			465	342	65.300,00

RECYCLED FLUID	Tipo pompa	Portata		Pressione			Riduttore		Potenza		€
	Pump type	L/min	US Gpm	bar	MPa	p.s.i.	g/min	r.p.m.	hp	kW	
	TR-R 50	398	105	400	40	5800	1500 / 1800 / 2200		414	304	65.900,00
	TR-R 55	482	127	350	35	5075	1500 / 1800 / 2200		438	322	65.900,00
	TR-R 60	573	151	300	30	4350	1500 / 1800 / 2200		446	328	65.900,00
	TR-R 65	673	178	250	25	3625	1500 / 1800 / 2200		437	321	65.900,00
	TR-R 70	781	206	220	22	3190	1500 / 1800 / 2200		446	328	65.900,00
	TR-R 75	896	237	200	20	2900	1500 / 1800 / 2200		465	342	65.900,00

CONNECTION KITS €

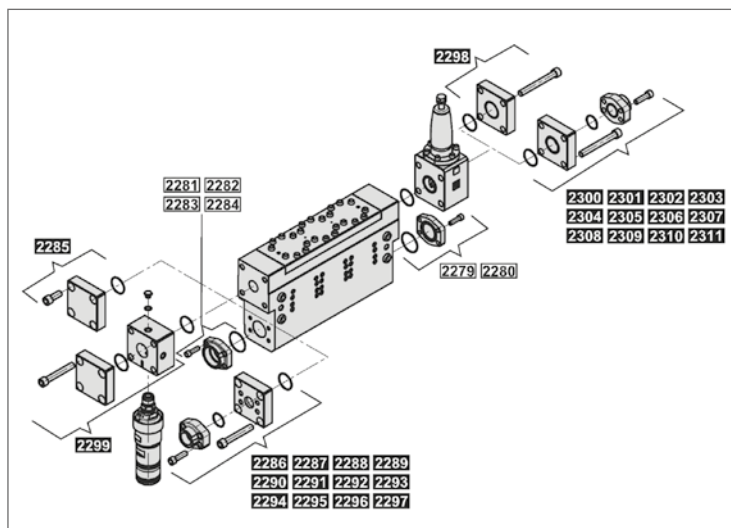

KIT2279	INLET	SAE 3000	Falnge Plug	SR TR all	STD	130,00
KIT2280	INLET	SAE 3000	Falnge Plug	SR TR all	INOX	610,00
KIT2281	INLET	G 3"		SR TR all	ST5 2.3	189,00
KIT2282	INLET	G 3"		SR TR all	INOX	849,00
KIT2283	INLET	NPT 3"		SR TR all	ST5 2.3	213,00
KIT2284	INLET	NPT 3"		SR TR all	INOX	770,00
KIT2285	OUTLET	Falnge Plug		SR TR all	INOX	820,00
KIT2286	OUTLET	SAE 6000 G 1" 1/2		SR TR 50	ST5 2.3	1.030,00
KIT2287	OUTLET	SAE 6000 G 1" 1/2		SR TR 50	INOX	1.551,00
KIT2288	OUTLET	SAE 6000 NPT 1" 1/2		SR TR 50	ST5 2.3	1.119,00
KIT2289	OUTLET	SAE 6000 NPT 1" 1/2		SR TR 50	INOX	1.495,00
KIT2290	OUTLET	SAE 6000 G 2"		SR TR 60-65	ST5 2.3	1.051,00
KIT2291	OUTLET	SAE 6000 G 2"		SR TR 60-65	INOX	1.721,00
KIT2292	OUTLET	SAE 6000 NPT 2"		SR TR 60-65	ST5 2.3	1.111,00
KIT2293	OUTLET	SAE 6000 NPT 2"		SR TR 60-65	INOX	1.686,00
KIT2294	OUTLET	SAE 6000 G 2" 1/2		SR TR 70-75	ST5 2.3	1.357,00
KIT2295	OUTLET	SAE 6000 G 2" 1/2		SR TR 70-75	INOX	2.360,00
KIT2296	OUTLET	SAE 6000 NPT 2" 1/2		SR TR 70-75	ST5 2.3	1.352,00
KIT2297	OUTLET	SAE 6000 NPT 2" 1/2		SR TR 70-75	INOX	3.192,00
KIT2298	OUTLET	Flange Plug RV		SR TR all	INOX	891,00
KIT2299	OUTLET	Safety Valve block + Plug		SR TR all	INOX	2.505,00
KIT2300	OUTLET	SAE 6000 G 1" 1/2 RV		SR TR 50	ST5 2.3	1.101,00
KIT2301	OUTLET	SAE 6000 G 1" 1/2 RV		SR TR 50	INOX	1.622,00
KIT2302	OUTLET	SAE 6000 NPT 1" 1/2 RV		SR TR 50	ST5 2.3	1.190,00
KIT2303	OUTLET	SAE 6000 NPT 1" 1/2 RV		SR TR 50	INOX	1.566,00
KIT2304	OUTLET	SAE 6000 G 2" RV		SR TR 60-65	ST5 2.3	1.122,00
KIT2305	OUTLET	SAE 6000 G 2" RV		SR TR 60-65	INOX	1.792,00
KIT2306	OUTLET	SAE 6000 NPT 2" RV		SR TR 60-65	ST5 2.3	1.182,00
KIT2307	OUTLET	SAE 6000 NPT 2" RV		SR TR 60-65	INOX	1.757,00
KIT2308	OUTLET	SAE 6000 G 2" 1/2 RV		SR TR 70-75	ST5 2.3	1.428,00
KIT2309	OUTLET	SAE 6000 G 2" 1/2 RV		SR TR 70-75	INOX	2.431,00
KIT2310	OUTLET	SAE 6000 NPT 2" 1/2 RV		SR TR 70-75	ST5 2.3	1.423,00
KIT2311	OUTLET	SAE 6000 NPT 2" 1/2 RV		SR TR 70-75	INOX	3.263,00



ATEX - II 2GD ck T4/T135°C

on request

TRHP series

450HP

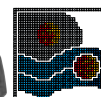

STANDARD	Tipo pompa Pump type	Portata Volume		Pressione Pressure			Riduttore r.p.m.			Potenza Power		€
		L/min	US Gpm	bar	MPa	p.s.i.	1:2,90	1:3,46	1:4,23	hp	kW	
	TR 26	108	28.5	1500	150	21750	1500 / 1800 / 2200			421	309	75.600,00
	TR 30	143	37.8	1200	120	17400	1500 / 1800 / 2200			446	328	75.600,00
	TR 32	163	43.0	1000	100	14500	1500 / 1800 / 2200			423	311	75.600,00
	TR 36	206	54.4	800	80	11600	1500 / 1800 / 2200			428	315	75.600,00

CONNECTION KITS

€

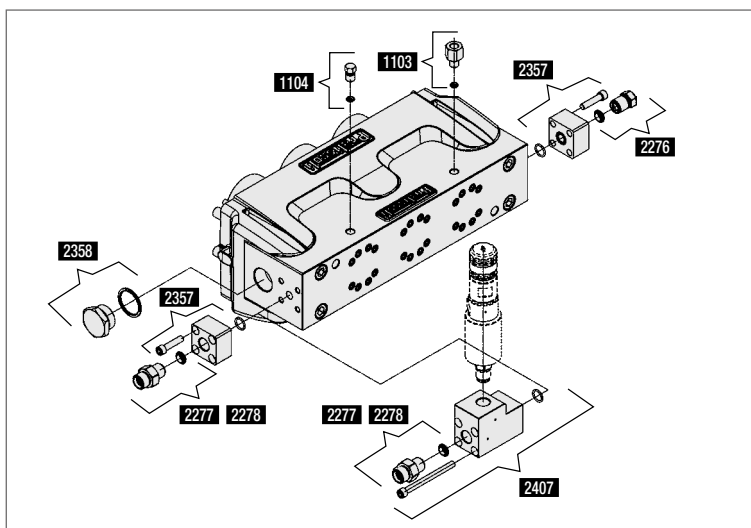

KIT1103	OUTLET	G 1/2" HP - G 1/2"	338,00
KIT1104	OUTLET	G 1/2" HP	235,00
KIT2276	OUTLET	G 1"	343,00
KIT2277	OUTLET	G 1" - M24 x 1,5	495,00
KIT2278	OUTLET	G 1" - M36 x 2	513,00
KIT2357	OUTLET	G 1"	462,00
KIT2358	INLET	G 2" HP	204,00
KIT2407	OUTLET	G 1" HP	1.662,00



ATEX - II 2GD ck T4/T135°C

on request

KT45M series

10HP



Tipo pompa Pump type	Valvole Valves	Cilindri Sleeves	g/min r.p.m.	Portata Volume		Pressione Pressure			Potenza Power		€
				L/min	US Gpm	bar	MPa	p.s.i.	hp	kW	
KT 45M	Sfera/Ball	Ceramic	600	74	19.6	50	5	750	9,6	7,1	4.400,00

HY-PACK (Standard)

€



ORBITAL 100 cc.

5.430,00



ZRPM1

166,00

DRIVE OPTIONS

€

€



Predisposizione per motore idraulico
SAE J744-B albero scanalato
13T 16/32 DP
*Hydraulic motor mount SAE J744-B
splined shaft 13T 16/32 DP*

209,00



Predisposizione presa di forza
ausiliaria opposta albero moto
Auxiliary P.T.O. opposite to shaft side

217,00



Flangia supporto per
azionamenti diretti
Flange for direct drive mount

155,00



ZFH70SB - Kit campana per
accoppiamento a motori idraulici
SAE J 744 tipo B-B
*ZFH70SB - Bell housing for
SAE J 744 B-B hydraulic motor*

312,00



ZGH70SB - Giunto flessibile
ZGH70SB - Flexible coupling

382,00

KF5M series

40HP

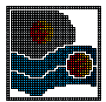

Tipo pompa Pump type	Valvole Valves	Cilindri Sleeves	g/min r.p.m.	Portata Volume		Pressione Pressure			Potenza Power		€
				L/min	US Gpm	bar	MPa	p.s.i.	hp	kW	
KF5M 5B	Sfera/Ball	Ceramic	600	177	46.7	50	5	750	23,0	16,9	5.990,00
KF5M 9B	Sfera/Ball	Acciaio/Steel	600	177	46.7	80	8	1160	36,8	27,0	5.990,00

HY-PACK (Standard)

€



ORBITAL 100 cc.

7.090,00

ORBITAL 120 cc.

7.420,00

ORBITAL 200 cc.

7.450,00



ZRPM1

166,00

DRIVE OPTIONS

€

€



Predisposizione per motore idraulico
SAE J744-C albero scanalato
14T 12/24 DP
*Hydraulic motor mount SAE J744-C
spline shaft 14T 12/24 DP*

230,00



Predisposizione presa di forza
ausiliaria opposta albero moto
Auxiliary P.T.O. opposite to shaft side

268,00



Flangia supporto per
azionamenti diretti
Flange for direct drive mount

155,00



ZFH71SC - Kit campana per
accoppiamento a motori idraulici
SAE J 744 tipo C
*ZFH71SC - Bell housing for SAE J
744 C hydraulic motor*

322,00



Riduttore / Gearbox
R 1:1,25 - R 1:1,5 - R 1:1,83

1.180,00



ZGH71SC - Giunto flessibile
ZGH71SC - Flexible coupling

481,00

MF7M series

50HP



Tipo pompa Pump type	Valvole Valves	Cilindri Sleeves	Riduttore / Gearbox r.p.m.				Portata Volume		Pressione Pressure			Potenza Power		€
			1:1,875	1:2,238	1:2,722	1:3,211	L/min	US Gpm	bar	MPa	p.s.i.	hp	kW	
MF7M 5B	Sfera Ball	Ceramic	400	490	600	700	202	53.3	50	5	750	26,2	19,2	13.110,00
MF7M 5D	Piattello Disc	Ceramic	500	600	740	880	254	67.1	50	5	750	33,0	24,3	13.110,00
MF7M 7B	Sfera Ball	Acciaio Steel	400	490	600	700	202	53.3	75	7,5	1090	39,4	29,0	13.110,00
MF7M 7D	Piattello Disc	Acciaio Steel	500	600	740	880	254	67.1	75	7,5	1090	49,5	36,4	13.110,00

HY-PACK (Standard)

€



ORBITAL 120 cc.

14.770,00



ZRPM1

166,00

DRIVE OPTIONS

€

€



Predisposizione per motore idraulico
SAE J744-C albero scanalato
14T 12/24 DP
*Hydraulic motor mount SAE J744-C
spline shaft 14T 12/24 DP*

504,00



Predisposizione presa di forza
ausiliaria opposta albero moto
Auxiliary P.T.O. opposite to shaft side

316,00



Presa diretta senza riduttore
800 g/min
Direct drive without gearbox
800 r.p.m.

- 600,00

MK9M series

80HP

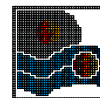

Tipo pompa Pump type	Valvole Valves	Cilindri Sleeves	Riduttore / Gearbox r.p.m.				Portata Volume		Pressione Pressure			Potenza Power		€
			1:1,61	1:2,222	1:2,65	1:3,29	L/min	US Gpm	bar	MPa	p.s.i.	hp	kW	
MK9M 5B	Sfera Ball	Ceramic	470	650	770	950	397	105	50	5	750	51,6	37,9	16.470,00
MK9M 5D	Piattello Disc	Ceramic	470	650	770	950	397	105	50	5	750	51,6	37,9	16.470,00
MK9M 8B	Sfera Ball	Acciaio Steel	470	650	770	950	397	105	80	8	1090	82,5	60,7	16.470,00
MK9M 8D	Piattello Disc	Acciaio Steel	470	650	770	950	397	105	80	8	1090	82,5	60,7	16.470,00

HY-PACK (Standard)

€



ORBITAL 100 cc.

17.760,00



ZRPM1

166,00

DRIVE OPTIONS

€



Predisposizione per motore idraulico
SAE J744-C albero scanalato
14T 12/24 DP
*Hydraulic motor mount SAE J744-C
spline shaft 14T 12/24 DP*

504,00



Predisposizione per motore idraulico
SAE J744-D albero scanalato
13T 30° 8/16 DP
*Hydraulic motor mount SAE J744-D
spline shaft 13T 30° 8/16 DP*

504,00

Accessori - Accessories



CERTIFIED SAFETY VALVES

€



■ S723 - For pumps KE - KT - KF - HF - KS - MW - MK - MKS

412,00



■ S1503 - For pumps VFH - VKH - SM14 - KV

1.032,00

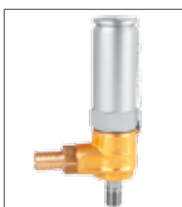

■ S1510 - For pumps SM - SKH

1.250,00



■ S1520 - For pumps SRhp - TRhp

2.115,00



■ S455 lp - For pumps MW - MK - MKS - LK - MF

562,00

■ S455 hp - For pumps MW - MK - MKS - LK - MF

792,00



■ S4090 - For pumps SRlp - TRlp

2.780,00

REGULATING VALVES

€



■ R1 200 - For pumps KE - KT - KF - KS

527,00

■ R1 400 - For pumps KE - KT - KF - KS

527,00

■ R1 600 - For pumps KE - KT - KF - KS

527,00



■ R2 - For pumps KT - KF - KS

711,00

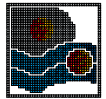

REGULATING VALVES

€



■ R2L - For pumps KT - KF - KS

815,00



■ TIMAX 100 - For pumps KE - KT - KTM - KFM - MWM - MKM

157,00



■ R3LP - For pumps MW - MK - MKS - LK

1.025,00



■ R3HP - For pumps MW - MK - MKS - LK

1.025,00



■ R1503 - For pumps VFH - VKH - SM14

2.678,00



■ R1510 - For pumps SM - SKH

3.710,00



■ R1520 - For pumps SRhp - TRhp

5.284,00



■ R4090 - For pumps SRlp - TRlp

5.980,00

Accessori - Accessories



UNLOADER VALVES

€



■ BH210 - For pumps KE - KT

468,00



■ H560 - For pumps KE - KT - HF

789,00



■ BKX600 - For pumps KE - KT - HF

1.240,00



■ RA2 - For pumps KT - KF - KS

960,00



■ RA2L - For pumps KT - KF - KS

1.072,00

PNEUMATIC VALVES

€



■ PN2 - For pumps KE - KT - KF - KS - MW

1.887,00



■ PN4 - For pumps MW - MK - MKS - LK

2.772,00



■ PNR2 - For pumps KT - KF - KS

1.315,00

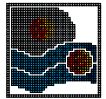

PNEUMATIC VALVES

€



■ PNRA2 - For pumps KT - KF - KS

1.534,00



■ PNR1503 - For pumps VFH - VKH - SM14

3.340,00



■ PNR1510 - For pumps SM - SKH

3.908,00



■ PNR1520 - For pumps SRhp - TRhp

5.977,00



■ PNR4090 - For pumps SRIp - TRIp

6.670,00

S.S. MAX. PRESSURE SETTING VALVES

€



■ SX2 - For pumps SS70 - SN70 - SN71 - HFN

552,00



■ SX3 - For pumps MWN - LKN

884,00

Accessori - Accessories



S.S. REGULATING VALVES

€



■ R1X 200 - For pumps SS70 - SN70 - SN71 - HFN 1.065,00

■ R1X 400 - For pumps SS70 - SN70 - SN71 - HFN 1.065,00

■ R1X 600 - For pumps SS70 - SN70 - SN71 - HFN 1.065,00



■ R3Xlp - For pumps MWN - LKN 3.373,00



■ R3Xhp - For pumps MWN - LKN 3.373,00

FILTERS

€



■ F10 - For pumps KE - KT - HF 433,00



■ F30 - For pumps KE - KT - KF - KS 179,00



■ F40 - For pumps KS - MW - MK - MKS - LK 320,00



■ F50/80 - For pumps VFH - VKH 1.677,00



■ F60 - For pumps SM - SKH 9.980,00

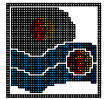

SPRAY GUNS

€



■ P560/750 - For ALL PUMPS

611,00

■ P560/1000 - For ALL PUMPS

641,00



■ P560S/750 - For ALL PUMPS

694,00

■ P560S/1000 - For ALL PUMPS

722,00



■ P15/750 - For pumps VF - VK - SM - SK

2.524,00

■ P15/1000 - For pumps VF - VK - SM - SK

2.642,00

ROTATING NOZZLES

€



■ RMAX 750 - For pumps HF - VF - VK - SM - SK

930,00



■ RMAX 1500 - For pumps VF - VK - SM - SK

2.240,00

NOZZLES

€



■ N1 - For spray guns 560 - 560S

17,00



■ N3/0° - For spray guns 560 - 560S - P15 Type A

119,00



■ N3/30° - For spray guns 560 - 560S - P15 Type A

257,00



■ N3/40° - For spray guns 560 - 560S - P15 Type A

257,00



■ N4/0° - For spray guns P15 Type B

166,00

Accessori - Accessories



PNEUMATIC DUMPING VALVES

€



■ PN15 - For pumps VF - VK - SM - SK - SRhp - TRhp **2.110,00**



■ PN14/800 - For pumps VF - VK - SM - SK - SRhp - TRhp **2.875,00**



■ PN14/1500 - For pumps VF - VK - SM - SK - SRhp - TRhp **2.875,00**

PULSATION DAMPENERS

€



■ A4X - SS 316 L - For pumps KE - KT - Standard connection **472,00**

■ A4X - SS 316 L - For pumps KE - KT - Inox connection **595,00**



■ A7 - For pumps KT - KF **253,00**



■ A7S - For pumps KT - KF **335,00**



■ A7X - SS 316 L - For pumps SS70 - SN70 - MWN **2.905,00**



■ A15 - For pumps MW - MK - MKS - LK **1.058,00**



■ A15X - SS 316 L - For pumps MWK - LKN **3.774,00**

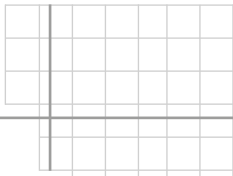
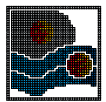

PRESSURE GAUGE

€



■ PG1 - For ALL PUMPS	29,00
■ PG2 - For ALL PUMPS	47,00
■ PG2/1000 - For ALL PUMPS	447,00



■ PG3/1000 - For ALL PUMPS	717,00
■ PG3/1600 - For ALL PUMPS	866,00

PRESSURE GAUGE SEPARATORS

€



■ SD1 - For pumps KT45M - KF5M - MF7M - MK9M	210,00
--	--------



■ SM40 - For pumps KT45M - KF5M - MF7M - MK9M	610,00
---	--------



■ SM50 - For pumps KT45M - KF5M - MF7M - MK9M	1.495,00
---	----------

CHECK VALVE

€



■ UD1 - For pumps KE - KT - KF - HF - MW - (5 bar / 73 psi)	264,00
■ UD1 - For pumps KE - KT - KF - HF - MW - (0,2 bar / 3 psi)	264,00

FOOT VALVE

€

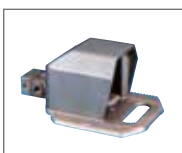

■ VP15 - For pumps VF - WK - SM - SKH - HF	1.572,00
--	----------

SLIDE

€

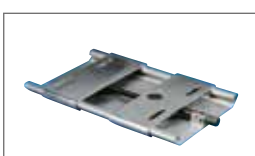

■ TC-G - For pumps KE - KT - KF - HF - VFH	282,00
--	--------

Tubi alta pressione - High pressure hoses

PILOTFLEX 120

Ø (inch)	Steel Braid	I.D. (mm)	O.D. (mm)	W.P. (bar/psi)	B.P. (bar/psi)	Weight (kg/m)	Bend Radius (kg/m)
3/16"	Single	5	8,4	120/1750	480/7000	0,148	20
1/4"	Single	6	10,3	120/1750	480/7000	0,158	25
5/16"	Single	8	11,8	120/1750	480/7000	0,192	30

Pilotflex 120

Cod.	Description	€
ZT03A0100152	TUBO 3/16 x 010 M 1/8 - F 1/4 SWJ120	71,00
ZT03A0150152	TUBO 3/16 x 015 M 1/8 - F 1/4 SWJ120	102,00
ZT03A0200152	TUBO 3/16 x 020 M 1/8 - F 1/4 SWJ120	133,00
ZT03A0105252	TUBO 3/16 x 010 F 1/4 - F 1/4 SWJ120	69,00
ZT03A0155252	TUBO 3/16 x 015 F 1/4 - F 1/4 SWJ120	100,00
ZT03A0205252	TUBO 3/16 x 020 F 1/4 - F 1/4 SWJ120	132,00
ZT03A0105252	TUBO 3/16 x 010 F 1/4 - F 1/4 SWJ120	72,00
ZT03A0155252	TUBO 3/16 x 015 F 1/4 - F 1/4 SWJ120	104,00
ZT03A0205252	TUBO 3/16 x 020 F 1/4 - F 1/4 SWJ120	135,00
ZT04A0100252	TUBO 1/4 x 010 M 1/4 - F 1/4 SWJ120	68,00
ZT04A0150252	TUBO 1/4 x 015 M 1/4 - F 1/4 SWJ120	100,00
ZT04A0200252	TUBO 1/4 x 020 M 1/4 - F 1/4 SWJ120	132,00
ZT04A0105252	TUBO 1/4 x 010 F 1/4 - F 1/4 SWJ120	68,00
ZT04A0155252	TUBO 1/4 x 015 F 1/4 - F 1/4 SWJ120	99,00
ZT04A0205252	TUBO 1/4 x 020 F 1/4 - F 1/4 SWJ120	131,00
ZT04A0100202	TUBO 1/4 x 010 M 1/4 - M 1/4 SWJ120	68,00
ZT04A0150202	TUBO 1/4 x 015 M 1/4 - M 1/4 SWJ120	100,00
ZT04A0200202	TUBO 1/4 x 020 M 1/4 - M 1/4 SWJ120	132,00
ZT05A0100252	TUBO 5/16 x 010 M 1/4 - F 1/4 SWJ120	81,00
ZT05A0150252	TUBO 5/16 x 015 M 1/4 - F 1/4 SWJ120	117,00
ZT05A0200252	TUBO 5/16 x 020 M 1/4 - F 1/4 SWJ120	154,00
ZT05A0105252	TUBO 5/16 x 010 F 1/4 - F 1/4 SWJ120	80,00
ZT05A0155252	TUBO 5/16 x 015 F 1/4 - F 1/4 SWJ120	117,00
ZT05A0205252	TUBO 5/16 x 020 F 1/4 - F 1/4 SWJ120	153,00
ZT05A0100202	TUBO 5/16 x 010 M 1/4 - M 1/4 SWJ120	82,00
ZT05A0150202	TUBO 5/16 x 015 M 1/4 - M 1/4 SWJ120	118,00
ZT05A0200202	TUBO 5/16 x 020 M 1/4 - M 1/4 SWJ120	155,00

Pilotflex 120 matasse e raccordi / skeins and fittings

Cod.	Description	€
ZT03A1200000	TUBO 3/16 x 120 - SWJ120	751,00
	Boccola	1,00
	Femmina	3,00
ZT04A1200000	Maschio	4,00
	TUBO 1/4 x 120 - SWJ120	766,00
	Boccola	1,00
ZT05A1200000	Femmina	1,00
	Maschio	2,00
	TUBO 5/16 x 120 - SWJ120	880,00
ZT05A1200000	Boccola	1,00
	Femmina	3,00
	Maschio	4,00

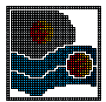

SEWERJET 280

Ø (inch)	Steel Braid	I.D. (mm)	O.D. (mm)	W.P. (bar/psi)	B.P. (bar/psi)	Weight (kg/m)	Bend Radius (kg/m)
3/8"	Single	10	15,7	280/4000	700/10150	0,25	60
1/2"	Double	13	20,4	280/4000	700/10150	0,53	90
3/4"	Double	19	27,5	280/4000	700/10150	0,77	100
1"	Double	25	36	280/4000	700/10150	1,17	130
1" 1/4	Double	31	43	280/4000	700/10150	1,53	200

Sewerjet 280

Cod.	Description	€	Cod.	Description	€
ZT06B0400353	TUBO 3/8 x 040 M 3/8 - F 3/8 SWJ280	229,00	ZT12B1005656	TUBO 3/4 x 100 F 3/4 - F 3/4 SWJ280	1.080,00
ZT06B0500353	TUBO 3/8 x 050 M 3/8 - F 3/8 SWJ280	285,00	ZT12B1205656	TUBO 3/4 x 120 F 3/4 - F 3/4 SWJ280	1.294,00
ZT06B0600353	TUBO 3/8 x 060 M 3/8 - F 3/8 SWJ280	341,00	ZT12B0500606	TUBO 3/4 x 050 M 3/4 - M 3/4 SWJ280	547,00
ZT06B0800353	TUBO 3/8 x 080 M 3/8 - F 3/8 SWJ280	453,00	ZT12B0600606	TUBO 3/4 x 060 M 3/4 - M 3/4 SWJ280	654,00
ZT06B1000353	TUBO 3/8 x 100 M 3/8 - F 3/8 SWJ280	566,00	ZT12B0800606	TUBO 3/4 x 080 M 3/4 - M 3/4 SWJ280	868,00
ZT06B0405353	TUBO 3/8 x 040 F 3/8 - F 3/8 SWJ280	229,00	ZT12B1000606	TUBO 3/4 x 100 M 3/4 - M 3/4 SWJ280	1.083,00
ZT06B0505353	TUBO 3/8 x 050 F 3/8 - F 3/8 SWJ280	285,00	ZT12B1200606	TUBO 3/4 x 120 M 3/4 - M 3/4 SWJ280	1.297,00
ZT06B0605353	TUBO 3/8 x 060 F 3/8 - F 3/8 SWJ280	341,00	ZT16B0600757	TUBO 1 x 060 M 1 - F 1 SWJ280	831,00
ZT06B0805353	TUBO 3/8 x 080 F 3/8 - F 3/8 SWJ280	453,00	ZT16B0800757	TUBO 1 x 080 M 1 - F 1 SWJ280	1.101,00
ZT06B1005353	TUBO 3/8 x 100 F 3/8 - F 3/8 SWJ280	565,00	ZT16B1000757	TUBO 1 x 100 M 1 - F 1 SWJ280	1.372,00
ZT06B0400303	TUBO 3/8 x 040 M 3/8 - M 3/8 SWJ280	229,00	ZT16B1200757	TUBO 1 x 120 M 1 - F 1 SWJ280	1.642,00
ZT06B0500303	TUBO 3/8 x 050 M 3/8 - M 3/8 SWJ280	285,00	ZT16B1500757	TUBO 1 x 150 M 1 - F 1 SWJ280	2.048,00
ZT06B0600303	TUBO 3/8 x 060 M 3/8 - M 3/8 SWJ280	341,00	ZT16B0605757	TUBO 1 x 060 F 1 - F 1 SWJ280	828,00
ZT06B0800303	TUBO 3/8 x 080 M 3/8 - M 3/8 SWJ280	454,00	ZT16B0805757	TUBO 1 x 080 F 1 - F 1 SWJ280	1.098,00
ZT06B1000303	TUBO 3/8 x 100 M 3/8 - M 3/8 SWJ280	566,00	ZT16B1005757	TUBO 1 x 100 F 1 - F 1 SWJ280	1.369,00
ZT08B0500454	TUBO 1/2 x 050 M 1/2 - F 1/2 SWJ280	378,00	ZT16B1205757	TUBO 1 x 120 F 1 - F 1 SWJ280	1.639,00
ZT08B0600454	TUBO 1/2 x 060 M 1/2 - F 1/2 SWJ280	453,00	ZT16B1505757	TUBO 1 x 150 F 1 - F 1 SWJ280	2.045,00
ZT08B0800454	TUBO 1/2 x 080 M 1/2 - F 1/2 SWJ280	602,00	ZT16B0600707	TUBO 1 x 060 M 1 - M 1 SWJ280	834,00
ZT08B1000454	TUBO 1/2 x 100 M 1/2 - F 1/2 SWJ280	752,00	ZT16B0800707	TUBO 1 x 080 M 1 - M 1 SWJ280	1.104,00
ZT08B1200454	TUBO 1/2 x 120 M 1/2 - F 1/2 SWJ280	901,00	ZT16B1000707	TUBO 1 x 100 M 1 - M 1 SWJ280	1.374,00
ZT08B0505454	TUBO 1/2 x 050 F 1/2 - F 1/2 SWJ280	379,00	ZT16B1200707	TUBO 1 x 120 M 1 - M 1 SWJ280	1.645,00
ZT08B0605454	TUBO 1/2 x 060 F 1/2 - F 1/2 SWJ280	453,00	ZT16B1500707	TUBO 1 x 150 M 1 - M 1 SWJ280	2.050,00
ZT08B0805454	TUBO 1/2 x 080 F 1/2 - F 1/2 SWJ280	603,00	ZT20B0600858	TUBO 1-1/4 x 060 M 1-1/4 - F 1-1/4 SWJ280	2.128,00
ZT08B1005454	TUBO 1/2 x 100 F 1/2 - F 1/2 SWJ280	752,00	ZT20B0800858	TUBO 1-1/4 x 080 M 1-1/4 - F 1-1/4 SWJ280	2.826,00
ZT08B1205454	TUBO 1/2 x 120 F 1/2 - F 1/2 SWJ280	901,00	ZT20B1000858	TUBO 1-1/4 x 100 M 1-1/4 - F 1-1/4 SWJ280	3.523,00
ZT08B0500404	TUBO 1/2 x 050 M 1/2 - M 1/2 SWJ280	378,00	ZT20B1200858	TUBO 1-1/4 x 120 M 1-1/4 - F 1-1/4 SWJ280	4.221,00
ZT08B0600404	TUBO 1/2 x 060 M 1/2 - M 1/2 SWJ280	453,00	ZT20B1500858	TUBO 1-1/4 x 150 M 1-1/4 - F 1-1/4 SWJ280	5.267,00
ZT08B0800404	TUBO 1/2 x 080 M 1/2 - M 1/2 SWJ280	602,00	ZT20B0605858	TUBO 1-1/4 x 060 F 1-1/4 - F 1-1/4 SWJ280	2.133,00
ZT08B1000404	TUBO 1/2 x 100 M 1/2 - M 1/2 SWJ280	751,00	ZT20B0805858	TUBO 1-1/4 x 080 F 1-1/4 - F 1-1/4 SWJ280	2.830,00
ZT08B1200404	TUBO 1/2 x 120 M 1/2 - M 1/2 SWJ280	900,00	ZT20B1005858	TUBO 1-1/4 x 100 F 1-1/4 - F 1-1/4 SWJ280	3.528,00
ZT12B0500656	TUBO 3/4 x 050 M 3/4 - F 3/4 SWJ280	546,00	ZT20B1205858	TUBO 1-1/4 x 120 F 1-1/4 - F 1-1/4 SWJ280	4.225,00
ZT12B0600656	TUBO 3/4 x 060 M 3/4 - F 3/4 SWJ280	653,00	ZT20B1505858	TUBO 1-1/4 x 150 F 1-1/4 - F 1-1/4 SWJ280	5.272,00
ZT12B0800656	TUBO 3/4 x 080 M 3/4 - F 3/4 SWJ280	867,00	ZT20B0600808	TUBO 1-1/4 x 060 M 1-1/4 - M 1-1/4 SWJ280	2.124,00
ZT12B1000656	TUBO 3/4 x 100 M 3/4 - F 3/4 SWJ280	1.081,00	ZT20B0800808	TUBO 1-1/4 x 080 M 1-1/4 - M 1-1/4 SWJ280	2.821,00
ZT12B1200656	TUBO 3/4 x 120 M 3/4 - F 3/4 SWJ280	1.296,00	ZT20B1000808	TUBO 1-1/4 x 100 M 1-1/4 - M 1-1/4 SWJ280	3.519,00
ZT12B0505656	TUBO 3/4 x 050 F 3/4 - F 3/4 SWJ280	544,00	ZT20B1200808	TUBO 1-1/4 x 120 M 1-1/4 - M 1-1/4 SWJ280	4.217,00
ZT12B0605656	TUBO 3/4 x 060 F 3/4 - F 3/4 SWJ280	652,00	ZT20B1500808	TUBO 1-1/4 x 150 M 1-1/4 - M 1-1/4 SWJ280	5.263,00
ZT12B0805656	TUBO 3/4 x 080 F 3/4 - F 3/4 SWJ280	866,00			



Imballaggio - Packages

Tipo pompa Pump type	Dimensions AxBxC (cm)		Gross weight Kg		Net Price €	
	Pump without gearbox	Pump with gearbox	Pump without gearbox	Pump with gearbox	Pump without gearbox	Pump with gearbox
	A - B - C	A - B - C				
KE	65 x 45 x 40	—	41	—	25,00	—
KT _{LP}	65 x 45 x 40	—	45	—	25,00	—
KT _{Hp}	65 x 45 x 40	—	45	—	25,00	—
KT45M	65 x 45 x 40	—	47	—	25,00	—
KV	65 x 45 x 40	—	45	—	25,00	—
70SN	65 x 45 x 40	—	48	—	25,00	—
KF	65 x 45 x 45	80 x 60 x 45	75	90	25,00	39,00
71SN	65 x 45 x 45	80 x 60 x 45	74	89	25,00	39,00
KF5M	80 x 60 x 45	80 x 60 x 45	83	98	39,00	39,00
KS	80 x 60 x 45	80 x 60 x 45	90	105	39,00	39,00
HS	80 x 60 x 45	80 x 60 x 45	73	88	39,00	39,00
MW	—	95 x 95 x 55	—	297	—	48,00
MWN	—	95 x 95 x 55	—	297	—	48,00
MF	—	95 x 95 x 55	—	297	—	48,00
MF7M	—	95 x 95 x 55	—	292	—	48,00
MK 40/45/50	—	105 x 86 x 55	—	420	—	59,00
MK 55/60/65	—	105 x 86 x 55	—	434	—	59,00
MK-R 50	—	105 x 86 x 55	—	420	—	59,00
MK-R 55/60/65	—	105 x 86 x 55	—	434	—	59,00
MK9M	—	105 x 86 x 55	—	434	—	59,00
MKS 40/45/50	—	105 x 86 x 55	—	420	—	59,00
MKS 55/60/65	—	105 x 86 x 55	—	434	—	59,00
MKS-R 50	—	105 x 86 x 55	—	420	—	59,00
MKS-R 55/60/65	—	105 x 86 x 55	—	434	—	59,00
LK 36/40/45	—	105 x 86 x 55	—	400	—	59,00
LK 50/55/60	—	105 x 86 x 55	—	410	—	59,00
LKN 36/40/45	—	105 x 86 x 55	—	400	—	59,00
HF	65 x 45 x 45	80 x 60 x 45	69	84	25,00	39,00
HFN	65 x 45 x 45	80 x 60 x 45	69	84	25,00	39,00
VFH	80 x 60 x 45	80 x 60 x 45	73	88	39,00	39,00
VKH	80 x 60 x 45	80 x 60 x 45	74,5	89,5	39,00	39,00
SM	105 x 86 x 55	105 x 86 x 55	270	305	59,00	59,00
SK	—	130 x 85 x 55	—	413,5	—	70,00
SR Horiz.	—	137 x 117 x 83	—	1205	—	298,00
SR Vert.	—	137 x 82 x 150	—	1195	—	298,00
TR Horiz.	—	137 x 117 x 83	—	1230	—	298,00
TR Vert	—	137 x 82 x 150	—	1220	—	298,00

Pratissoli - a brand of INTERPUMP GROUP S.p.A.

General Conditions of Sale of Interpump Group S.p.A. (hereinafter referred to as "Interpump")

Art. 1 (scope)

These General Conditions of Sale form an integral part of any offer, purchase order, and order confirmation. Any agreement on different terms must be approved in writing by Interpump.

1.2. The Products are sold with retention of title. Transfer of ownership shall occur only after the full payment of the purchase price.

Art. 2 (prices)

2.1. The prices of Products are expressed in Euro and are shown in the Price List. Prices are intended ex works (EXW) net of packaging, taxes, and any insurance.

Art. 3 (product specifications)

3.1. The technical specifications of Products are indicative and may be changed without notice. The Customer shall be responsible for choosing the Products ordered and determining the suitability of the product to their requirements. Interpump reserves the right to make changes to Products at any time and is under no obligation to notify the Customer of such changes.

Art. 4 (delivery methods and terms)

4.1. Products will be delivered at Interpump's warehouse directly to the Customer or to the appointed carrier or forwarding agent.

4.2. Delivery dates are approximate and not binding for Interpump. The delivery date refers to the day of departure from Interpump's warehouse. Any delay in delivery or partial fulfillment of the order does not give the customer the right to cancel or claim compensation for direct or indirect losses, or to delay the payment of deliveries already made with respect to the agreed deadlines.

Art. 5 (suspension of delivery)

5.1. Failure to pay, even in part, of any delivery, shall give Interpump the right to suspend the deliveries underway even if they refer to products whose payment terms have not yet expired or for items already paid.

Art. 6 (solve et repete)

6.1. Customers may not take legal action or file claims for Product flaws, discrepancies or otherwise, unless the agreed payment terms have fully been complied with.

Art. 7 (warranty for defects, exemption from liability)

7.1. Interpump products are warranted to be free from defects in workmanship for a period of 12 months from the date of shipping. The warranty is limited to the repair or replacement of those parts, at our sole discretion, which prove to be clearly defective, with the exception of parts subject to wear. The Products under warranty must be sent on freight prepaid basis to Interpump Group S.p.A., via E. Fermi n. 25, 42049 S. Ilario D'Enza (RE), where they will be examined and repaired or replaced if necessary. The warranty expressly excludes any damage, loss, service, shipping or return shipping costs, generated by wilful misconduct, negligence, improper use, tampering, freezing, atmospheric or natural events, damage during transport, failure to comply with installation and maintenance rules, the use of non-genuine spare parts.

7.2. The original warranty period will not be extended under any circumstances by repairs made under warranty.

7.3. The warranty terms as described in these General Conditions of Sale shall be the only warranty terms applied, thereby excluding any further or different statutory warranty.

Art. 8 (returns)

8.1. Interpump does not accept customer returns for repairs or other reasons unless they have been agreed with and authorised by Interpump in advance.

Art. 9 (payment)

9.1. Payments shall be made according to the terms and conditions agreed and specified in the invoice. In case of non-payment, Interpump reserves the right to charge default interest and the expenses incurred, pursuant to Legislative Decree 231/2002. Interpump shall have the right to suspend the processing of any orders due to failure to comply with the payment terms and conditions. In case of late payments, Interpump shall use any credit notes issued up to the limit of the credit to offset against amount due.

Art. 10 (Interpump Code of Ethics)

10.1. Violation by the Customer of the provisions of the Code of Ethics shall constitute a serious breach pursuant to Article 1453 of the Italian Civil Code and may result in termination of contract and compensation for the resulting damages.

Art. 11 (competent court)

11.1. Any disputes related to the contract of sale and the application of these General Conditions of Sale shall be submitted to the exclusive jurisdiction of the Court of Reggio Emilia.

Pratissoli - a brand of INTERPUMP GROUP S.p.A.

Conditions générales de vente de Interpump Group S.p.A. (ci-après "Interpump"):

Art. 1 (champ d'application)

1.1. Les présentes Conditions Générales de vente font partie intégrante de toute offre, commande et confirmation de commande. Tout autre accord devra être approuvé par écrit par Interpump.

1.2. Les Produits sont vendus sous réserve de propriété. La propriété est transférée uniquement après paiement intégral du prix d'achat.

Art. 2 (prix)

2.1. Les prix des Produits sont exprimés en Euros et sont indiqués dans le Tarif. Les prix sont départ usine (EXW) hors emballage, taxes et éventuelle assurance.

Art. 3 (caractéristiques des Produits)

3.1. Les données techniques des Produits sont indicatives et peuvent être modifiées sans préavis. Le Client est responsable du choix des produits commandés et qu'ils correspondent à ses propres exigences. Interpump se réserve le droit d'apporter à n'importe quel moment des modifications aux Produits, sans obligation de communication au Client.

Art. 4 (termes et modalité de livraison)

4.1. La livraison est effectuée à l'entrepôt d'Interpump directement au Client ou au transporteur chargé de la livraison.

4.2. La date de livraison est indicative et non contraignante et se réfère à la date de départ de l'entrepôt d'Interpump. Le retard éventuel de la livraison ou la livraison partielle ne donne au Client ni le droit de résiliation ni de prétendre un dédommagement pour préjudices directs ou indirects, ni de retarder le paiement des fournitures déjà effectuées par rapport aux échéances convenues.

Art. 5 (suspension de la livraison)

5.1. Le non-paiement, même partiel, de n'importe quelle fourniture, donne droit à Interpump de suspendre les livraisons en cours même si elles se réfèrent à des Produits dont le paiement n'est pas encore arrivé à échéance ou à des lots déjà payés.

Art. 6 (solve et repete)

6.1. En cas de dispute, le Client ne pourra faire valoir les défauts, les difformités des Produits ou autres, que s'il respecte les délais de paiement convenus.

Art. 7 (garantie des vices, décharge de responsabilité)

7.1. Les Produits Interpump sont garantis sans défaut de fabrication pendant 12 mois à compter de l'expédition. La garantie est limitée à la réparation ou remplacement des pièces qui, à notre seul jugement, s'avèreraient manifestement défectueuses, à l'exception des pièces d'usure. Les Produits sous garantie devront être envoyés en port payé à Interpump Group S.p.A., via E. Fermi n. 25, 42049 S. Ilario D'Enza (RE), pour être examinés, réparés ou éventuellement remplacés. De la garantie sont expressément exclus les dommages, pertes, coûts d'intervention, expédition, réexpédition éventuels, défauts générés intentionnellement, négligence, usage impropre, détérioration, gel, événements atmosphériques et naturels, dommages lors du transport, inobservance des normes d'installation, emploi de pièces non originales.

7.2. L'intervention sous garantie ne prolongera d'aucune façon la durée de la garantie en question.

7.3. La garantie décrite dans les présentes conditions sera la seule reconnue par Interpump, à l'exclusion de toute autre garantie légale.

Art. 8 (retours de produits)

8.1. Interpump n'accepte pas de retours de produits des clients pour réparation ou autres raisons, sauf si cela est préalablement convenu avec et autorisé par Interpump.

Art. 9 (paiements)

9.1. Les paiements devront être effectués aux conditions convenues et indiquées dans la facture. En cas de non-paiement, Interpump se réserve de facturer les intérêts et les frais encourus, comme prévu par le Décret Législatif 231/2002. L'inobservance des délais de paiement donne faculté à Interpump d'interrompre la livraison des commandes suivantes. En cas de retard dans les paiements, Interpump compensera les notes de crédit éventuelles jusqu'à concurrence de ses propres créances.

Art. 10 (Code éthique d'Interpump)

10.1. La violation de la part du Client, des normes du Code Éthique, constitue un manquement grave aux termes de l'art. 1453 c.c. Et pourra comporter la résolution du contrat et le dédommagement des préjudices subis.

Art. 11 (tribunal compétent)

11.1. Pour tout différend relatif au contrat de vente et à l'application des présentes conditions seul le tribunal de Reggio Emilia sera compétent.

Art. 1 (Anwendungsbereich)

1.1. Die vorliegenden allgemeinen Verkaufsbedingungen sind einen wesentlichen Teil aller Angebote, Bestellungen und Auftragsbestätigungen. Alle abweichende Vereinbarungen müssen schriftlich von Interpump genehmigt werden.

1.2. Die Produkte werden unter Eigentumsvorbehalt verkauft. Das Eigentum geht erst nach vollständiger Bezahlung des Kaufpreises über.

Art. 2 (Preise)

2.1. Die Preise der Produkte werden in Euro in der Preisliste aufgeführt. Die Preise verstehen sich ab Werk (EXW) zzgl. Verpackung, Steuern und eventuelle Versicherungen.

Art. 3 (Eigenschaften der Produkte)

3.1. Die technischen Daten der Produkte sind Richtwerte und können ohne vorherige Ankündigung geändert werden. Der Kunde ist für die Wahl der bestellten Produkte und deren Übereinstimmung mit seinen Erfordernissen verantwortlich. Interpump behält sich vor, jederzeit Veränderungen an den Produkte vorzunehmen, ohne dass dabei die Pflicht zur Mitteilung an den Kunden besteht.

Art. 4 (Fristen und Formen der Lieferung)

4.1. Die Lieferung erfolgt ab dem Lager von Interpump direkt an den Kunden, an den Transporteur oder an die beauftragte Spedition.

4.2 Das Lieferdatum ist ein unverbindlicher Richtwert und bezieht sich auf das Abgangsdatum aus dem Lager von Interpump. Eine eventuelle Verspätung bei der Lieferung oder eine Teillieferung gibt dem Kunden weder ein Recht zur Kündigung, zur Forderung einer Entschädigung für direkte oder indirekte Schäden, noch zur Verspätung der Bezahlung der bereits ausgeführten Lieferungen hinsichtlich der vereinbarten Termine.

Art. 5 (Einstellung der Lieferung)

5.1. Die auch nur teilweise Nichtbezahlung einer beliebigen Lieferung begründet das Recht für Interpump, die laufenden Lieferungen einzustellen, auch wenn diese sich auf Produkte beziehen, deren Zahlungsfristen noch nicht abgelaufen sind, bzw. auf bereits beglichene Partien.

Art. 6 (Klausel "Solve et Repete")

6.1. Der Kunde kann in Form einer Klage oder eines Einwandes keine Mängel bzw. Abweichungen der Produkte oder anderes geltend machen, wenn die Zahlungsfristen nicht eingehalten werden.

Art. 7 (Gewährleistung für Mängel, Haftungsbefreiung)

7.1. Die Produkte von Interpump sind über eine Dauer von 12 Monaten nach Auslieferungsdatum frei von Herstellungsmängeln garantiert. Die Garantie ist auf die Reparatur oder den Austausch jener Teile beschränkt, die ausgenommen der Verschleißteile nach unserem ausschließlichen Ermessen, offensichtlich defekt sind. Die unter Garantie stehenden Produkte müssen frei Werk an Interpump Group S.p.A., Via E. Fermi Nr. 25, 42049 S. Ilario D'Enza (RE) zur ihrer Prüfung und eventuellen Reparatur oder Ersetzung eingeschickt werden. Von der Garantie sind ausdrücklich eventuelle Schäden, Verluste, Kosten für Eingriffe, Versand oder Rücksendung, durch Vorsatz, Nachlässigkeit, unsachgemäßen Gebrauch, Veränderung, Frost-, Wetter- und Naturereignisse, Transport, Nichtbeachtung der Installations- und Wartungsvorschriften bzw. durch Einsatz von nicht-originalen Ersatzteilen hervorgerufenen Defekte ausgeschlossen.

7.2. Maßnahmen im Garantiezeitraum verlängern keinesfalls die Dauer dieser Garantie.

7.3. Die in den vorliegenden allgemeinen Verkaufsbedingungen beschriebene Garantie ist die einzige, die von Interpump anerkannt wird, wobei jede weitere oder andere gesetzliche Garantie ausgeschlossen wird.

Art. 8 (Rücklieferungen)

8.1. Interpump nimmt keine Rücklieferungen von Kunden zur Reparatur oder aus anderen Gründen an, wenn diese nicht zuvor vereinbart und von Interpump genehmigt wurden.

Art. 9 (Zahlungen)

9.1. Die Zahlungen müssen unter den vereinbarten und in der Rechnung angegebenen Bedingungen ausgeführt werden. Bei Nichtbezahlung behält sich Interpump vor, Verzugszinsen und aufgewandte Kosten in Rechnung zu stellen, wie in der Gesetzesverordnung 231/2002 vorgesehen ist. Die Nichteinhaltung der Zahlungsbedingungen stellt es Interpump frei, die Auslieferung weiterer Bestellungen zu unterbrechen. Bei Verzögerungen der Zahlungen verrechnet Interpump eventuell ausgestellte Gutschriften bis zur Höhe ihrer Forderung.

Art. 10 (Ethischer Code von Interpump)

10.1. Die Verletzung der Bestimmungen des ethischen Kodex durch den Kunden stellt eine schwere Nichterfüllung gemäß Art. 1453 ital. ZGB dar und kann auch die Kündigung des Vertrages sowie den Ersatz der daraus folgenden Schäden nach sich ziehen.

Art. 11 (Gerichtsstand)

11.1. Für alle Streitfälle in Bezug auf den Verkaufsvertrag und die Anwendung der vorliegenden allgemeinen Verkaufsbedingungen ist ausschließlich der Gerichtsstand von Reggio Emilia zuständig.

Art. 1 (ámbito de aplicación)

1.1. Las condiciones generales constituyen parte integrante de cualquier oferta, solicitud de compra y confirmación de pedido. Todo otro acuerdo en contrario deberá ser aprobado por escrito por la firma Interpump.

1.2. Los Productos se venden con pacto de dominio reservado. La propiedad se transfiere sólo tras el pago total del precio de compra.

Art. 2 (precios)

2.1. Los precios de los Productos están expresados en Euros y están indicados en la Lista de Precios. Los precios son franco fábrica (EXW) netos de los gastos de embalaje, impuestos y seguros.

Art. 3 (características de los Productos)

3.1. Los datos técnicos de los Productos son indicativos y pueden modificarse sin previo aviso. El cliente es responsable de la elección de los Productos solicitados y de su correspondencia con sus exigencias. Interpump se reserva la facultad de aportar en cualquier momento modificaciones a los Productos, sin obligación de comunicación al Cliente.

Art. 4 (términos y modalidades de entrega)

4.1. La entrega se realiza en el almacén de Interpump, directamente al Cliente o al vector o al transportista encargado.

4.2 La fecha de entrega se entiende indicativa y no vinculante, y se refiere a la fecha de salida desde el almacén de Interpump. La posible demora en la entrega o el despacho parcial del pedido no otorga derecho al cliente de anulación ni pretender indemnizaciones por daños directos o indirectos, ni retardar, respecto a los vencimientos pactados, el pago de los suministros ya realizados.

Art. 5 (suspensión de la entrega)

5.1. La falta de pago, incluso parcial, de cualquier suministro, otorga a Interpump el derecho a suspender las entregas en curso también si se refieren a Productos cuyos términos de pago aún no han vencido o con partidas ya pagadas.

Art. 6 (solve et repete) paga y reclama

6.1. El Cliente no podrá hacer valer, en vía de acción o excepción, defectos, deformidades de los Productos u otros, si no respeta los términos de pago acordados.

Art. 7 (garantía por vicios, exención de responsabilidad)

7.1. Los Productos Interpump están garantizados contra los defectos de fabricación durante el plazo de 12 meses desde la fecha de expedición. La garantía se limita a la reparación o sustitución de aquellas piezas que, según nuestro juicio exclusivo, demostraran defectos evidentes, con exclusión de las piezas de desgaste. Los Productos bajo garantía deberán enviarse con flete prepago a Interpump Group S.p.A, via E. Fermi n. 25, 42049 S. Ilario D'Enza (RE), para ser examinados y eventualmente reparados o sustituidos. De la garantía se excluyen expresamente los posibles daños, pérdidas, gastos de intervención, expedición o reenvío, defectos generados por dolo, negligencia, uso inapropiado, alteración, hielo, eventos atmosféricos y naturales, daños en el transporte, inobservancia de las normas de instalación y mantenimiento, empleo de piezas no originales.

7.2. La intervención en garantía no prolongará, en ningún caso, el período de validez de la garantía.

7.3. La garantía descrita en las presentes condiciones será la única válida, con exclusión de toda otra diferente garantía de ley.

Art.8 (devoluciones)

8.1. Interpump no acepta devoluciones de los clientes por reparación u otra causa, si no ha sido previamente acordado y autorizado por Interpump.

Art.9 (pagos)

9.1. Los pagos deberán realizarse a las condiciones acordadas e indicadas en la factura. En caso de falta de pago, Interpump se reserva el derecho de cobrar los intereses por mora y los gastos incurridos, como ha sido previsto por el D.Leg. 231/2002. La inobservancia de los términos de pago otorga a Interpump el derecho de suspender el despacho de pedidos posteriores. En caso de mora en los pagos, Interpump compensará posibles notas de crédito emitidas, hasta el importe de su crédito.

Art. 10 (Código ético de Interpump)

10.1. La violación, por parte del Cliente, de las normas del Código Ético, constituye incumplimiento grave ex art. 1453 del c.c. y podrá comportar también la rescisión del contrato y el resarcimiento de los daños consecuentes.

Art. 11 (Tribunal competente)

11.1. En caso de controversias referidas al contrato de venta y a la aplicación de las presentes condiciones será competente en vía exclusiva el Tribunal de Reggio Emilia.

Art. 1 (ambito di applicazione)

1.1. Le Condizioni Generali costituiscono parte integrante di qualsiasi offerta, ordine di acquisto e conferma d'ordine. Ogni diverso accordo dovrà essere approvato per iscritto da Interpump.

1.2. I Prodotti sono venduti con patto di riservato dominio. La proprietà viene trasferita solo a seguito del pagamento integrale del prezzo di acquisto.

Art. 2 (prezzi)

2.1. I prezzi dei Prodotti sono in euro e sono indicati nel Listino Prezzi. I prezzi si intendono franco fabbrica (EXW) al netto dell'imballo, delle imposte e di eventuali assicurazioni.

Art. 3 (caratteristiche dei Prodotti)

3.1. I dati tecnici dei Prodotti sono indicativi e possono essere modificati senza preavviso. Il Cliente è responsabile della scelta dei Prodotti ordinati e della loro rispondenza alle proprie esigenze. Interpump si riserva di apportare in qualsiasi momento modifiche ai Prodotti, senza obbligo di comunicazione al Cliente.

Art. 4 (termini e modalità di consegna)

4.1. La consegna viene effettuata, presso il magazzino di Interpump, direttamente al Cliente oppure al vettore o allo spedizioniere incaricato.

4.2. La data di consegna si intende indicativa e non vincolante, ed è riferita alla data di partenza dal magazzino di Interpump. L'eventuale ritardo nella consegna o l'evasione parziale dell'ordine non dà diritto al cliente di disdetta né di pretendere risarcimenti per danni diretti o indiretti, né di ritardare, rispetto alle scadenze convenute, il pagamento delle forniture già effettuate.

Art. 5 (sospensione della consegna)

5.1. Il mancato pagamento, anche parziale, di qualsiasi fornitura, dà diritto a Interpump di sospendere le consegne in corso anche se riferite a Prodotti i cui termini di pagamento non sono ancora scaduti o a partite già saldate.

Art. 6 (solve et repete)

6.1. Il Cliente non potrà far valere, in via di azione o eccezione, difetti, difformità dei Prodotti o altro, se non rispettando i termini di pagamento concordati.

Art. 7 (garanzia per vizi, esonero di responsabilità)

7.1. I Prodotti Interpump sono garantiti esenti da difetti di fabbricazione per la durata di 12 mesi dalla data di spedizione. La garanzia è limitata alla riparazione o sostituzione di quelle parti che, a ns. esclusivo giudizio, risultassero manifestamente difettose, escluso le parti di usura. I Prodotti soggetti alla garanzia dovranno essere inviati franco stabilimento di Interpump via E. Fermi n. 25, 42049 S. Ilario D'Enza (RE), per il loro esame ed eventuale riparazione o sostituzione. Dalla garanzia sono espressamente esclusi gli eventuali danni, perdite, costi di intervento, spedizione o rispedizione, difetti generati da dolo, negligenza, uso improprio, manomissione, gelo, eventi atmosferici e naturali, danneggiamenti nel trasporto, inosservanza delle norme di installazione e manutenzione, impiego di parti non originali.

7.2. L'intervento in garanzia non prolungherà in alcun caso il periodo di durata della garanzia stessa.

7.3. La garanzia descritta nelle presenti condizioni sarà l'unica operante, con esclusione di qualsiasi ulteriore o diversa garanzia di legge.

Art. 8 (resi)

8.1. Interpump non accetta resi da clienti per riparazione o altra causale, se non preventivamente concordati e autorizzati da Interpump stessa.

Art. 9 (pagamenti)

9.1. I pagamenti dovranno essere effettuati alle condizioni concordate e indicate in fattura. In caso di mancato pagamento, Interpump si riserva di addebitare gli interessi di mora e le spese sostenute, come previsto dal D.Lgs 231/2002. L'inosservanza dei termini di pagamento dà facoltà a Interpump di sospendere l'evasione di ulteriori ordini. In caso di ritardo nei pagamenti, Interpump compenserà eventuali note di credito emesse, fino alla concorrenza del proprio credito.

Art. 10 (Codice etico di Interpump)

10.1. La violazione, da parte del Cliente, delle norme del Codice Etico, costituisce inadempimento grave ex art. 1453 c.c. e potrà comportare anche la risoluzione del contratto e il risarcimento dei danni conseguenti.

Art. 11 (foro competente)

11.1. Per ogni controversia relativa al contratto di vendita ed all'applicazione delle presenti condizioni sarà competente in via esclusiva il Foro di Reggio Emilia.

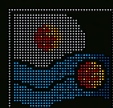

Pratissoli

A brand of



INTERPUMP GROUP

**AZIENDA CON SISTEMA
DI GESTIONE QUALITÀ
CERTIFICATO DA DNV
=ISO 9001=**

PRATISSOLI a brand of INTERPUMP GROUP S.P.A.

Via E. Fermi, 25 42049 S. Ilario (RE) Italy - Tel. +39 0522 904311 Fax +39 0522 904444

E-mail: info@pratissolipompe.com - <http://www.pratissolipompe.com>

INTERPUMP GROUP S.P.A.: C.C.I.A.A. R.E.A. N.204185

PART.IVA IT 01682900350 - REG.IMPRESSE R.E. - C.F.11666900151 - REG.A.E.E.: IT08020000000780